

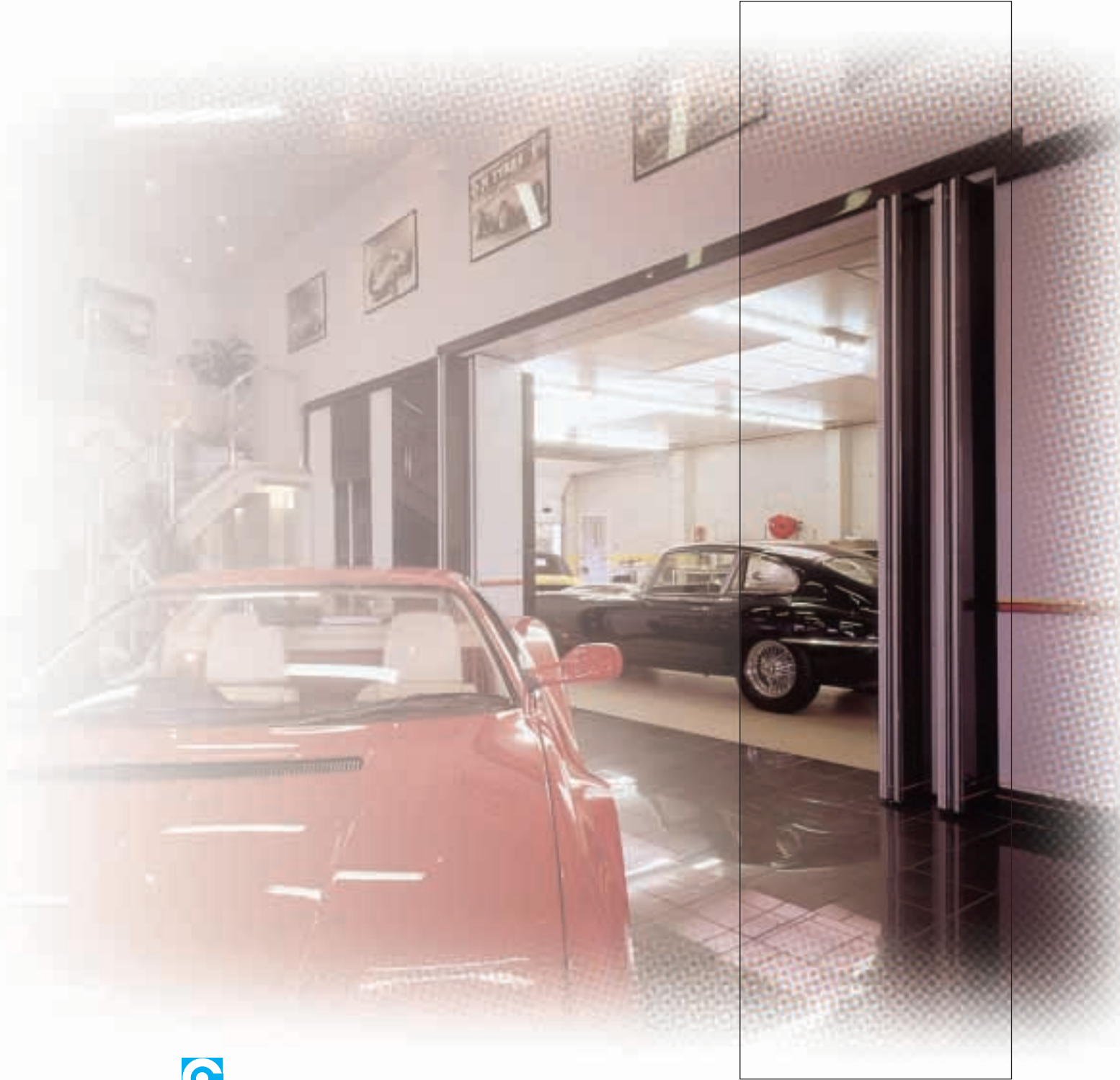

Uniclass	EPIC
L41103/4	D1111/2
CI/SfB	
(32.54)	X

APRIL 2003

# Coburn Movable Walls & Partitions



  
**COBURN**  
SLIDING SYSTEMS

# Coburn Movable Walls

## COBURN CONCERTINA 715 PAGES 6 & 7

Expanding partitions for normal problems of space division, bringing luxury wherever they are fitted, combined with a touch of modernity in their application.

## COBURN CONCERTINA 723 PAGES 6 & 7

An upgraded version of COBURN CONCERTINA 715 made with fibreglass quilt infill for improved sound reduction. Includes sweep seals on both sides, top and bottom.

## COBURN CONCERTINA 730 PAGES 6 & 7

Provides improved sound attenuation having, in addition to sweep seals, layers of dense-coated synthetic fabric and quilted fibreglass.



## COBURN WALLMASTER PARTITIONS PAGES 3, 4 & 5.

Sound reducing sliding and folding walls, consisting of single panels of a timber or steel construction.

Acoustic performance from RW 37dB to RW 52 dB. Should a higher rating be required please contact HILLALDAM COBURN for advice.

Approximate hanging weight from 39 kg/m<sup>2</sup> to 64 kg/m<sup>2</sup> depending on acoustic performance.

Generally supported from a No.7 overhead steel track with trolleys which allow ease of movement through 90° into stacking areas.

Panels can be centre or side stacking. Maximum opening height up to 6000mm (4000mm for centre stacking). Refer to HILLALDAM COBURN if above. Width is unlimited but governed by stacking capabilities. The width of each panel is constructed between 700mm and 1215mm.

The largest possible panel widths are used. Thickness 96mm or 100mm nominal. Panels have retractable top and bottom seals for ease of movement.

## GENERAL INFORMATION

COBURN CONCERTINA partitions are covered in a flame retardant heavy duty PVC coated fabric. A Class O Fire-Retardant finish to BS 476:1971 part 7 is available. This material gives an early warning of fire as it reacts to heat, releasing a vapour which activates an ionisation-type smoke detector before the fire ignites

COBURN WALLMASTER partition faces can be clad with Melamine Laminates from our standard range, Muraspec vinyls, Wood Veneers, Primer board for on site decoration (by others) or free issue materials (subject to testing). Pass doors may be incorporated in any “non operable” panel from 1100mm wide x 2400mm high in all COBURN WALLMASTER partitions. Refer to HILLALDAM COBURN for special widths and heights.

## COLOUR AVAILABILITY

COBURN CONCERTINA and COBURN WALLMASTER partitions are available in a wide range of standard colours. Please refer to HILLALDAM COBURN for samples or colour chart.

## FOLDASIDE AND CENTAFOLD DOOR GEARS

Hillaldam Coburn Ltd also manufacture a comprehensive range of sliding door fittings for interior timber folding partitions either top hung or bottom rolling with end or centrally hung door leaves. Information available upon request.

# Coburn Wallmaster

M937, M939, M942, M944, M946, M947, M949, M950, M952

## APPLICATION

A series of custom built sound reducing movable walls in single panels. Ideally suited for room separation of classrooms, conference rooms, clubs, restaurants etc.

## OPERATION

Single panels centre stacking, side or remote stacking. Refer to HILLALDAM COBURN for special layouts. Each panel positively locked into position by retractable top and bottom seals. Final closure accomplished by means of a lever operated expanding panel.

## PANEL

16mm particle board each side on a timber or steel frame, infilled with acoustic materials to achieve required performance. Extruded silver anodised aluminium edge trims with pvc seals, provide effective sealing.

**NOTE: VISION PANELS OR GLAZED PANELS AVAILABLE UPON REQUEST.**

## TRACK

No.7 steel fixed direct to hardwood or with brackets for alternative fixing arrangements. Duarol track for special layouts and Quadro for special layouts or excessively high partitions.

## TROLLEYS

Steel ball bearing swivel type – A range to suit all applications.

## COVERING

Panels can be clad with melamine laminates from our standard range, muraspec vinyls, wood veneers, primer board for on site decoration (by others) or free issue wall coverings.

## SEALING

Retractable top and bottom seals operated by handle via ratchet lock and spring loaded telescopic rods within the panels, which compensate for uneven floors.

## GENERAL

A pass door can be generally incorporated in any non operable panel 1100mm wide x 2400mm high minimum. Refer to HILLALDAM COBURN for special widths and heights.

## FIXING

Top hung system requiring adequate support facilities for the overhead track.

## SOUND ATTENUATION

All sound attenuation figures given are laboratory test results carried out under ideal conditions. It is generally accepted that in-situ site readings would give approx 5dB reduction for a good installation with possibly small further reductions where items such as pass doors and vision panels are included.



RANGE	M937	M939	M942	M944	M946	M947	M949	M950	M952
Acoustic Performance	RW37dB	RW39dB	RW42dB	RW44dB	RW46dB	RW47dB	RW49dB	RW50dB	RW52dB
Approx Hanging weight	39 kg/m <sup>2</sup>	41 kg/m <sup>2</sup>	44 kg/m <sup>2</sup>	46 kg/m <sup>2</sup>	48 kg/m <sup>2</sup>	49 kg/m <sup>2</sup>	53 kg/m <sup>2</sup>	58 kg/m <sup>2</sup>	64 kg/m <sup>2</sup>
Max. clear opening height	6000mm*	6000mm*	6000mm*	6000mm*	6000mm*	6000mm*	6000mm*	6000mm*	6000mm*
Max. opening width	Unlimited	Unlimited	Unlimited	Unlimited	Unlimited	Unlimited	Unlimited	Unlimited	Unlimited
Max. panel width	1215mm	1215mm	1215mm	1215mm	1215mm	1215mm	1215mm	1215mm	1215mm
Panel thickness	96mm	96mm	96mm	96mm	96mm	96mm	100mm	100mm	100mm

\*4000m for centre stacking

# Coburn Wallmaster

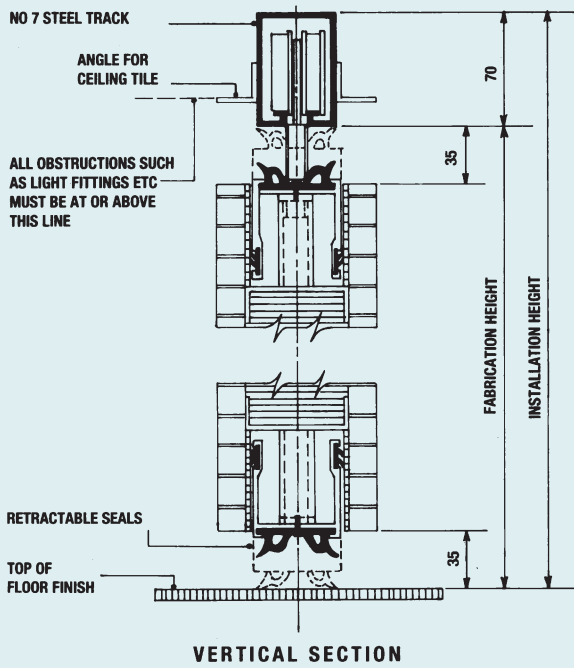

**INSTALLATION WIDTH**  
WIDTH BETWEEN TIMBER JAMBS

**FABRICATION WIDTH**  
INSTALLATION WIDTH MINUS 121mm  
(2 x 3mm MOULDS + 115 TRAVEL)

**PANEL WIDTH**  
FABRICATION WIDTH  
No OF PANELS

**INSTALLATION HEIGHT**  
TOP OF FLOOR FINISH TO U/S OF FIXING POINT

**FABRICATION HEIGHT**  
REFER TO HILLALDAM COBURN

**VERTICAL SECTION**

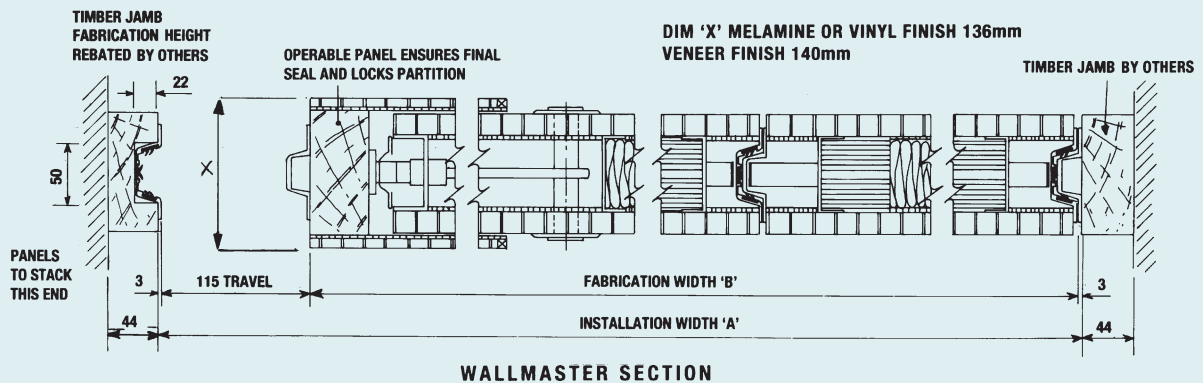

**WALLMASTER SECTION**

# Head Details & Stacking Arrangements

## Coburn Wallmaster

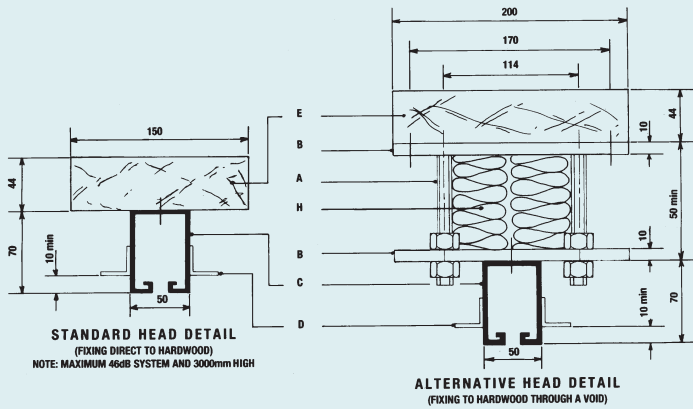

### KEY

- (A) 12mm Dia threaded rods by Hillaldam Coburn
  - (B) Top and bottom plates by Hillaldam Coburn
  - (C) No 7 steel track by Hillaldam Coburn
  - (D) Angle trim for suspended ceiling by Hillaldam Coburn
  - (E) Woodfixings by Hillaldam Coburn
  - (F) Lindaptors by Hillaldam Coburn
  - (G) Rawbolts/Throughbolts by Hillaldam Coburn
  - (H) Boxing/acoustic baffle by others
- (Refer to Hillaldam Coburn for advice)*

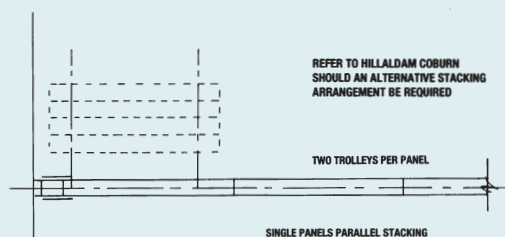
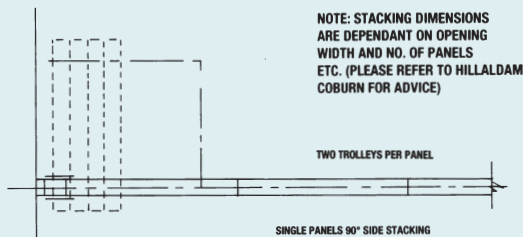
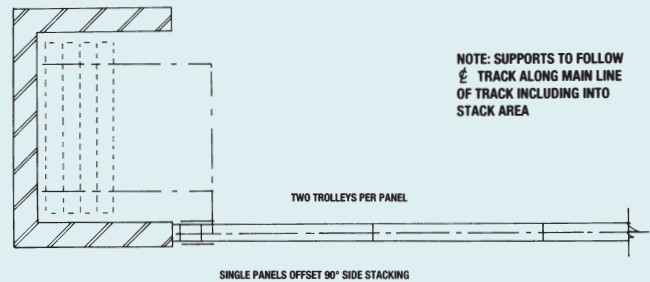
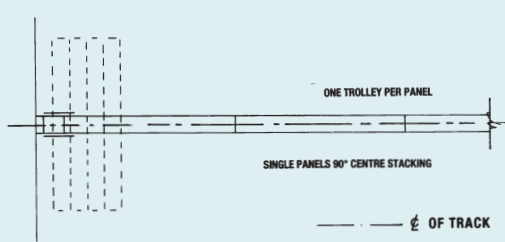
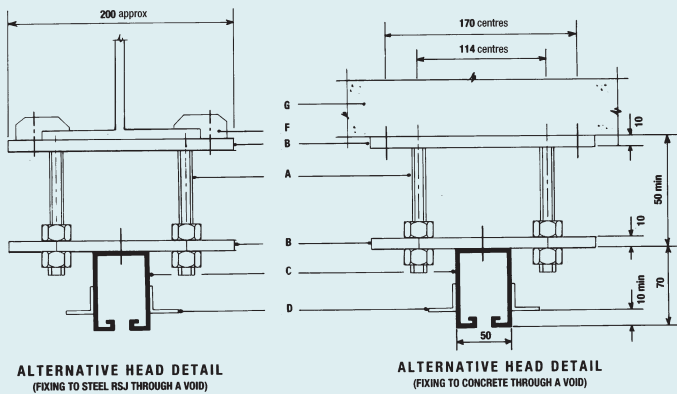

# Coburn Concertina

715, 723 & 730

## APPLICATION

A series of custom built expanding partitions for all normal problems of space division. For schools, hospitals, public buildings etc. Quiet in operation with vinyl seals on COBURN CONCERTINA 723 & 730 to reduce draughts.

RANGE	Concertina 715	Concertina 723	Concertina 730
Acoustic Performance	15dB	23dB	30dB
Approx hanging weight	8kg/m <sup>2</sup>	10.5kg/m <sup>2</sup>	18kg/m <sup>2</sup>
Maximum opening height	5000mm	5000mm	5000mm
Maximum opening width	Unlimited	Unlimited	Unlimited
Maximum leaf area before intermediate post required	16m <sup>2</sup>	12m <sup>2</sup>	7m <sup>2</sup>

Available in single units, pairs, or fully floating. All units made to order.

## CONSTRUCTION

- ▶ Protective heavy duty webbing sewn to outer PVC coated fabric with nylon thread and attached to hinge valley by self-locking clips
- ▶ Vertical rods connected to hinges form a rigid framework
- ▶ Carbon steel pantograph action hinged for evenness of fold
- ▶ Limit tape to prevent over-stretching
- ▶ Leading post trolley with ball bearing action and smooth running nylon tyres
- ▶ Extruded aluminium male and female closure strips with foam sealing pad
- ▶ Flame retardant heavy duty PVC coated fabric
- ▶ Adjustable rubber latex sealing strip



## ACCESSORIES

- ▶ Pendulum Pulls – standard on partitions over 2.4m high
- ▶ Drawlatch – standard where there are 2 partitions over 3.5m high. This draws the 2 partitions tightly together
- ▶ Tieback straps – fitted as standard to secure partition neatly when out of use. Finished to match partition colour.
- ▶ Locking – standard with 2 keys

## STACKING DEPTH

CONCERTINA 715	1/6th partition width + 125mm
CONCERTINA 723	1/5th partition width + 125mm
CONCERTINA 730	Dimensions on application

## SITE WORKS

A timber surround on walls and ceilings must be fitted prior to installation of the partition. Dimensions available on request.

## COLOURS

A wide range of colours is available as standard. Please refer to HILLALDAM COBURN for colour samples.

## A. PROPOSED HEAD DETAIL FOR STANDARD (715) PARTITION – EXPOSED TRACK

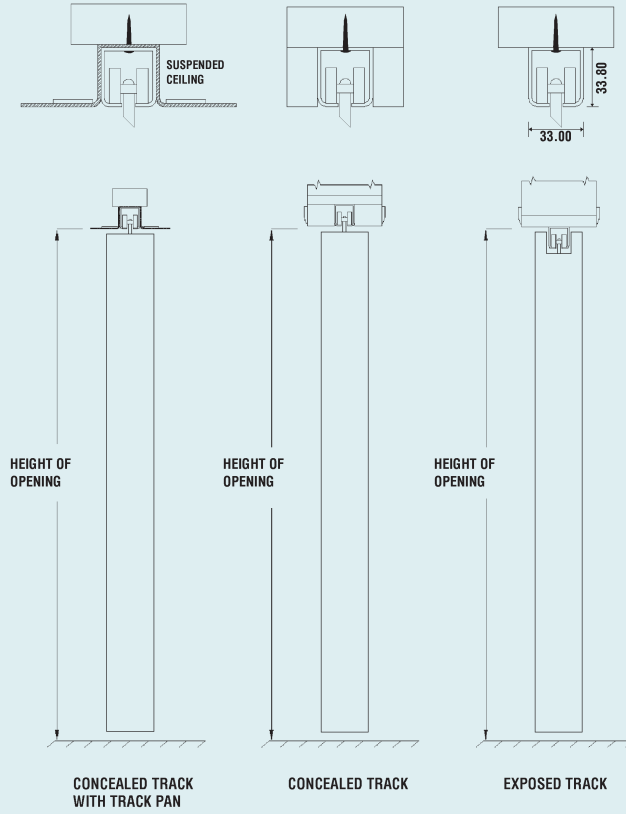

### STACK DIMENSIONS

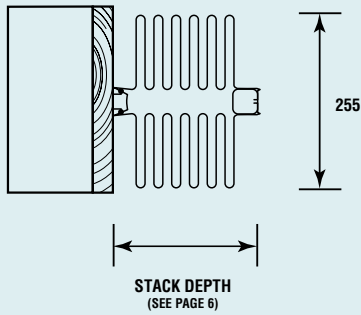

### 255x50MM TIMBER JAMB LININGS

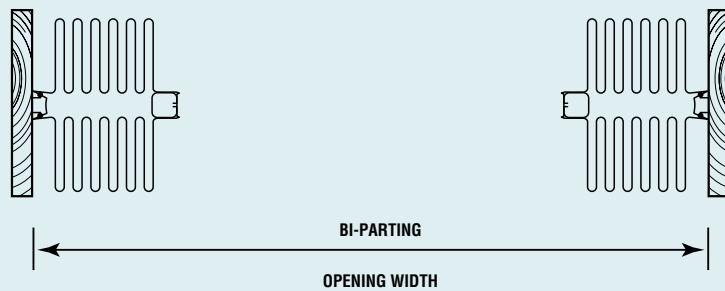

### 255x50MM TIMBER JAMB LININGS

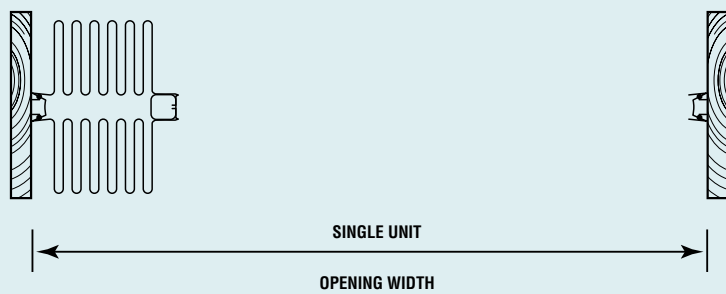

Note: Jams and Timber Linings not supplied by Hillaldam Coburn

Hillaldam Coburn has a history of commitment to quality and technical developments. Products are always produced to the appropriate British Standards and the company was one of the first in the industry to have operating procedures approved under BS EN ISO 9001.

Constant testing ensures that quality is maintained and a programme of product improvement is regularly reviewed and updated. The company is an active member of the Association of Builders' Hardware Manufacturers. Today Hillaldam Coburn is proud to remain in the forefront of the industry as we take a leading role in working with the British Standards Institute to develop the new European standards (CEN). The following range of literature is available on request:

### SLIDING DOOR GEAR

- Glassmaster 100
- Straightaway Door Gear
- Foldaside & Cornaway
- Interior Sliding Systems
- Centafold & Foldaside
- The Buyers Guide
- Supplementary Door Gears
- HIDEAWAY™ Pocket Door Kit

### OTHER COBURN PRODUCTS

- Automatic Operators
- Movable Walls & Partitions
- GLIDEMASTER™ Sliding Closures

Hillaldam Coburn Ltd. also offers an extensive range of Acoustic products for walls and floors through its subsidiary, Trim Acoustics. Comprehensive literature is available on request.



INVESTOR IN PEOPLE



Certificate No. FS 14679

The products designed and supplied by Hillaldam Coburn Ltd are covered by a Quality Assurance system in accordance with BS EN ISO 9001: 2000

### HILLALDAM COBURN LIMITED

#### HEAD OFFICE

Unit 6, Wyvern Estate,  
Beverley Way, New Malden,  
Surrey, KT3 4PH, England.

**Telephone:** 020 8336 1515

**International:** +44 20 8336 1515

**Facsimile:** 020 8336 1414

**Sales Freefax:** 0800 616623

**e-mail:** sales@hillaldam.co.uk

**Web:** www.coburn.co.uk

#### SCOTLAND

Unit 25 Baillieston Distribution Centre,  
Glasgow, G69 6UL, Scotland.

**Telephone:** 0141 771 6165

**Facsimile:** 0141 773 1693

**Sales Freefax:** 0800 318904

*The company reserves the right from time to time to make such alterations in design and manufacture as they consider necessary without notice. Drawings, specifications, illustrations, tables and other details are not binding in detail. Conditions of sale are as those published on the Company's tender forms.*