



## Flat Track 180

### Sliding & Folding Door Systems



#### Product Overview

The Flat Track 180 sliding hardware is a unique system ideal for barn conversions, cottages and renovations of listed buildings, where heavy rustic style doors are required to slide. The exposed hardware is extremely robust and is available in many finishes with a variety of hanger styles.

#### Features

- Durable steel strap hangers run freely across a solid steel flat bar
- Anti-jump blocks prevent door from being removed from the track
- Soft closing available for doors up to 100kgs
- Variety of hanger styles and finishes
- Precisely machined steel wheels featuring sealed ball bearings that are lifetime lubricated ensure a smooth running system
- Hydrographic design applications available upon request
- For internal use

#### Technical Specifications

- Maximum Door Weight: 180kg
- Minimum Door Width: 550mm
- Maximum Door Width: 1219mm
- Door Thickness: 35-44mm



Standard kit

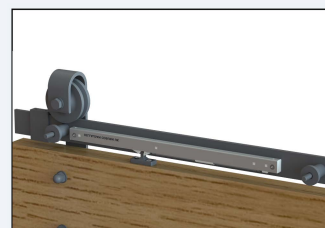

Soft closer  
(Fitted behind track)



Track stop

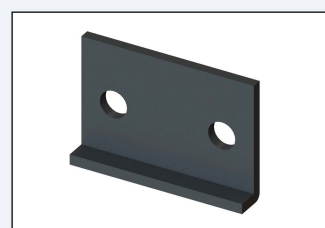

Jointing bracket

**Flat track  
180 kg system shown**

Maximum door weight 180kg

DWi - Door width

DT - Door thickness, between 35mm and 44mm

OW - Opening width

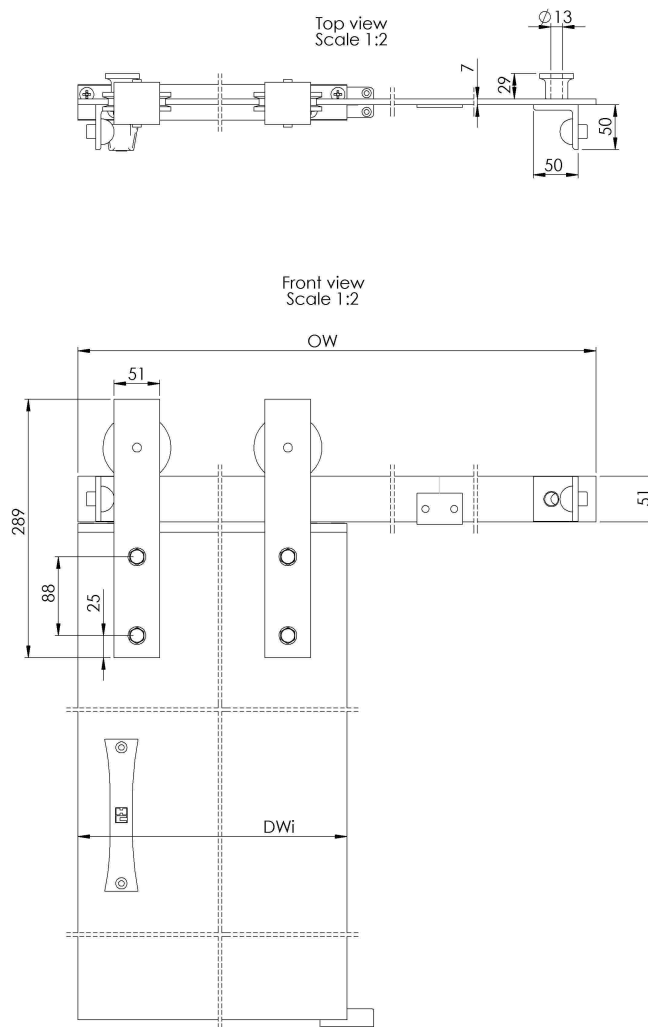
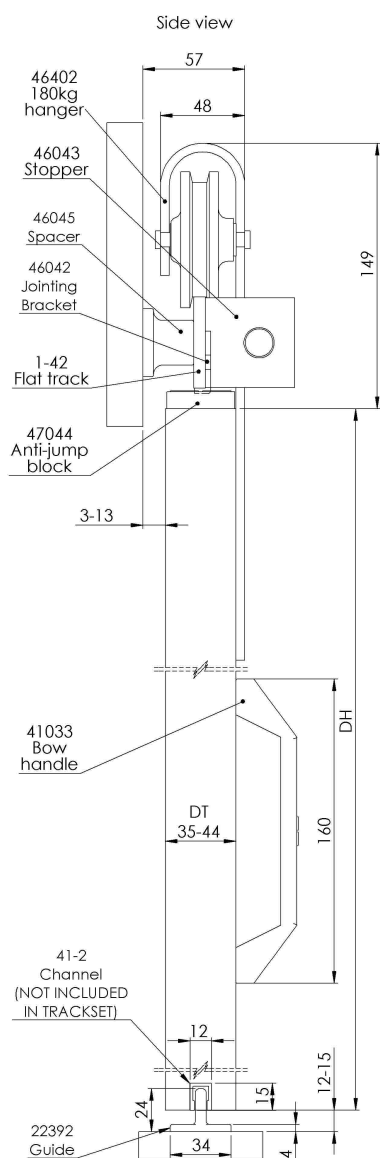
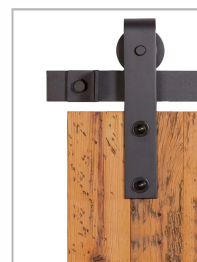
**Hanger Types**

\*Classic Straight

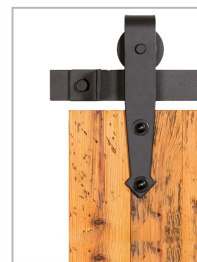

Arrowhead

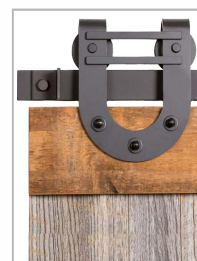

Horseshoe

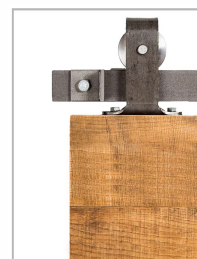

Top Mount

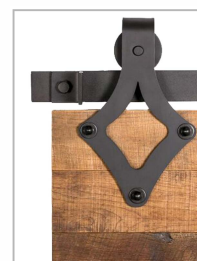

Wide Teardrop

**Finishes Available**

\*Black

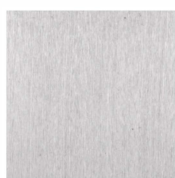

Brushed St/Steel



Weathered Rust

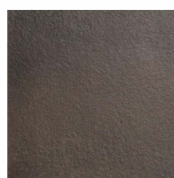

Painted Bronze



Brushed Nickel

\*Denotes Available Ex-stock.

**For further information on our products and services:**

Tel: +44 (0)20 8545 6680 sales@coburn.co.uk www.coburn.co.uk

**Coburn Sliding Systems**Unit 1, Cardinal West, Cardinal Way, Cardinal Distribution Park,  
Godmanchester, Huntingdon, Cambridgeshire, PE29 2XN United Kingdom.

Dealer Stamp