

# FITTING INSTRUCTIONS FOR FLEXIGLAS 120

## COMPONENTS



51120/30/40/60 - Anodized Aluminium



51230/40/60 - Satin Stainless Steel



51176 - Flexiglas fitting set, anodized aluminium, 120kg



51276 - Flexiglas fitting set, satin stainless steel, 120kg

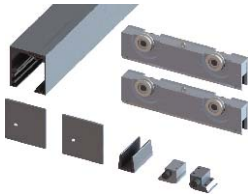

51182/3 - Flexiglas 120 standard kit, anodized aluminium

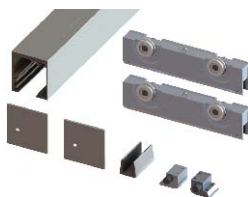

51282 - Flexiglas 120 standard kit, satin stainless steel

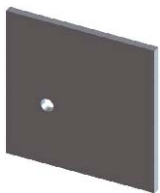

51171 - End caps (set of 2), anodized aluminium



51271 - End caps (set of 2), satin stainless steel



51192 - Flexiglas 120, double soft closing kit, 80kg

## Required tools

Allen Key



Spanner



Power screw driver



Posi drive screw bit



Drill bit



# Technical Specifications

## FLEXIGLAS 120

Maximum door weight 120kg

DH - Door height, maximum 2700mm

DWi - Door width

DT - Door thickness, 8mm or 10mm

OW - Opening width

OH - Opening height

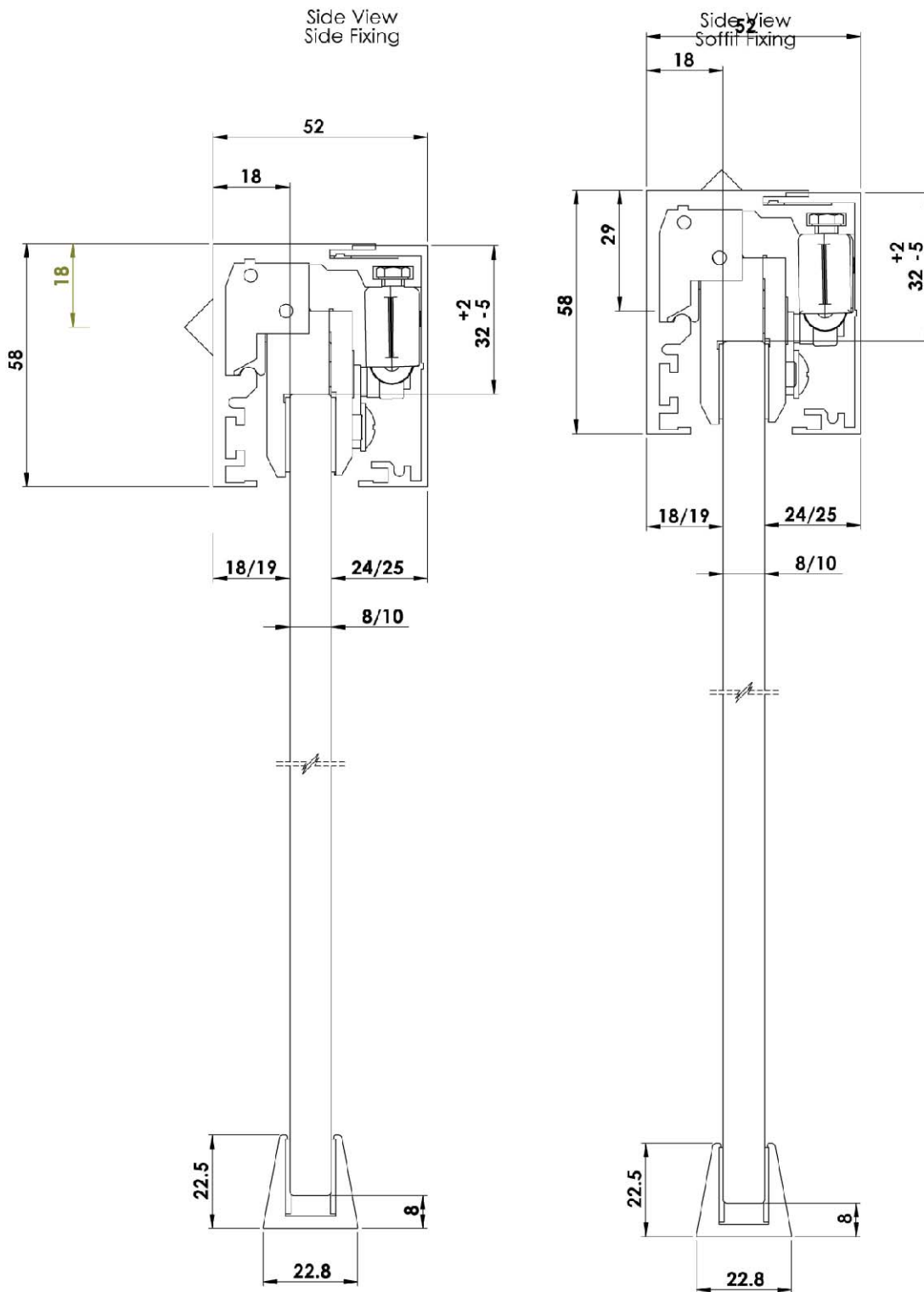

# Step 1 Fixing track

Face Fixed: track comes pre-drilled, mark the position of the levelled track on the wall and fix it with screws

Soffit Fixed: track needs to be pre-drilled, mark the ceiling and fix the track with screws

Face Fix



Soffit Fix



# Step 2 Door hardware overview

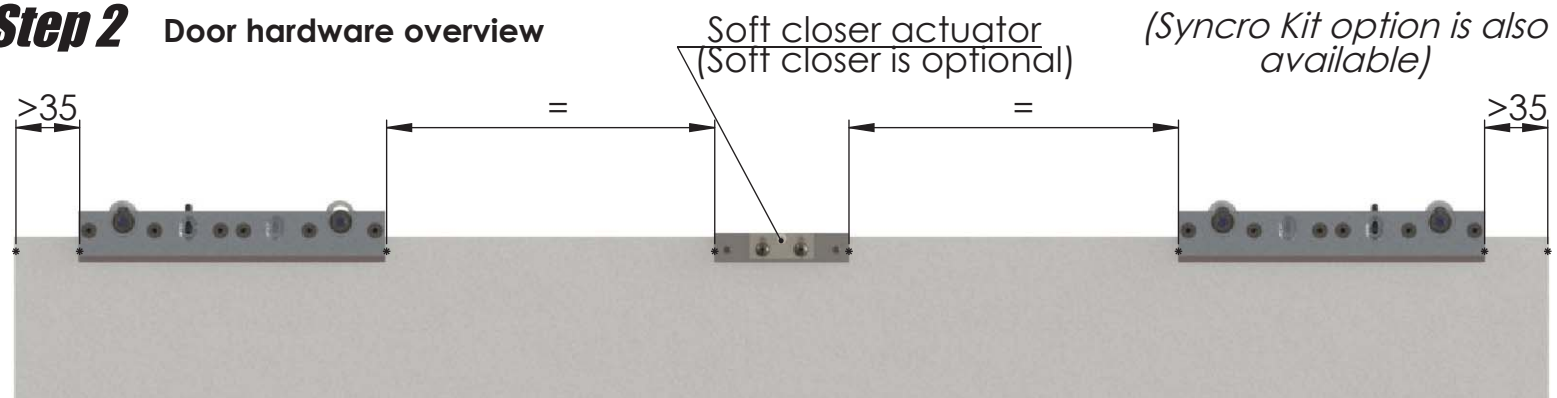

*(Syncro Kit option is also available)*

8mm door

10mm door

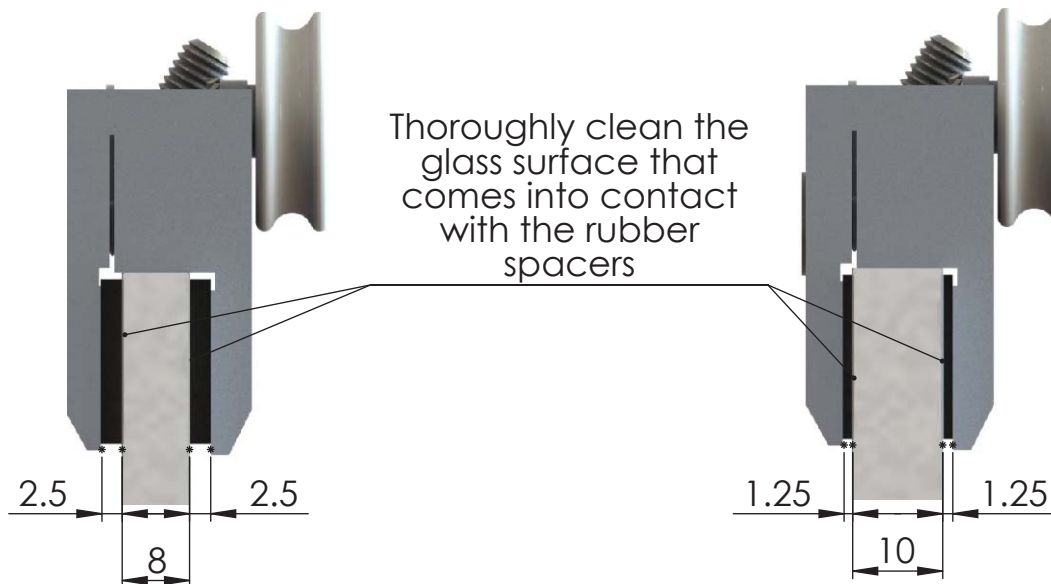

**Step 3** Prepare hangers and fix with 8mm door

**NOTE:** If you opted for a soft closer or syncro kit also refer to the appropriate instructions

a. Prepare all required components

b. Insert the rubber spacers on each side between the door and the hanger

c. Tighten the screws with 12Nm force

d. Insert the grub screw

**DO NOT USE GLUE**

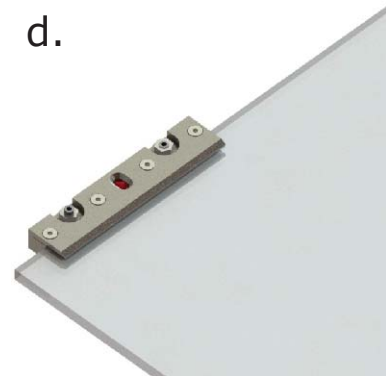
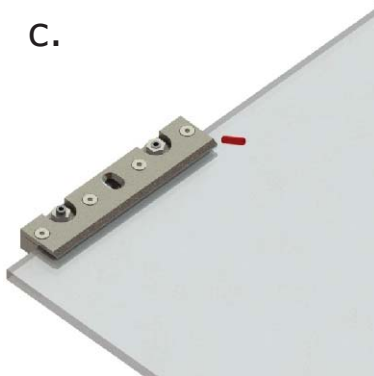
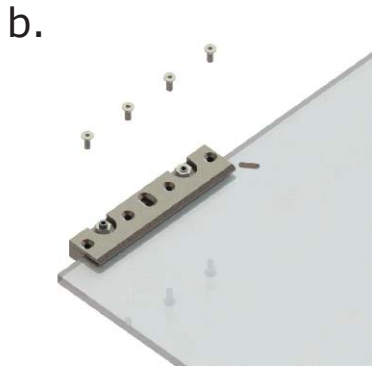
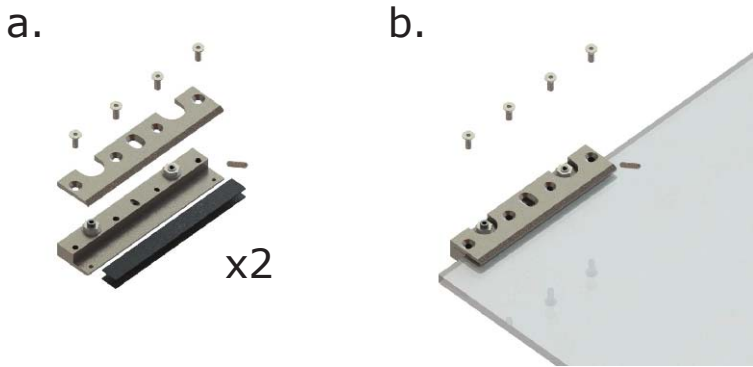

**Step 4** Prepare hangers and fix with 10mm door

**NOTE:** If you opted for a soft closer or syncro kit also refer to the appropriate instructions

a. Prepare all required components

b. Insert the rubber spacers on each side between the door and the hanger

c. Tighten the screws with 12Nm force

d. Insert the grub screw

**DO NOT USE GLUE**

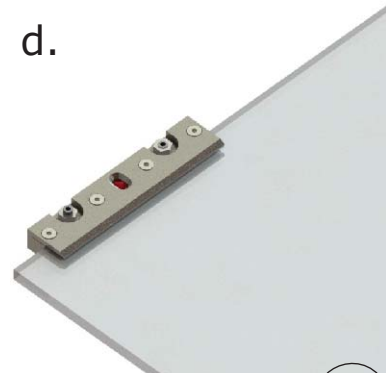
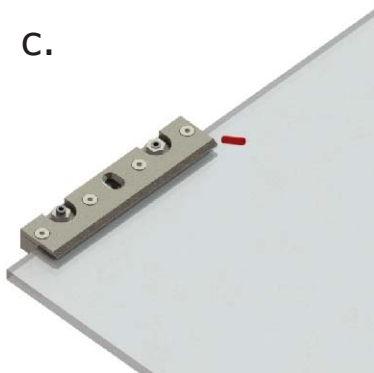
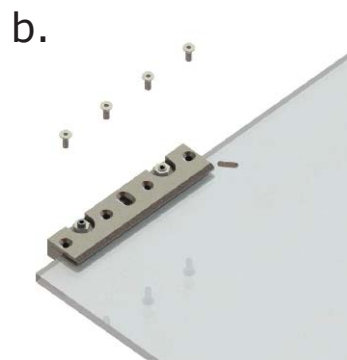
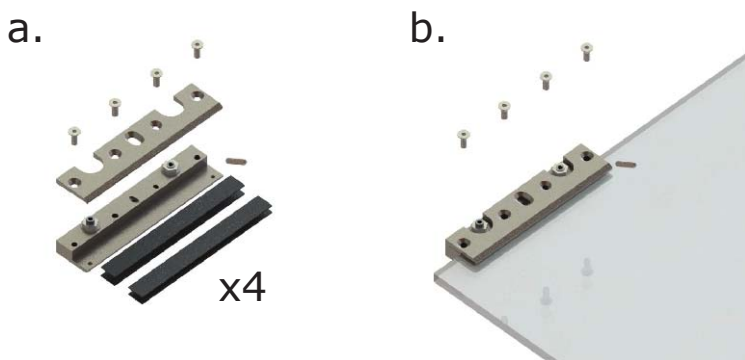

**Step 5** Insert door and hangers into track

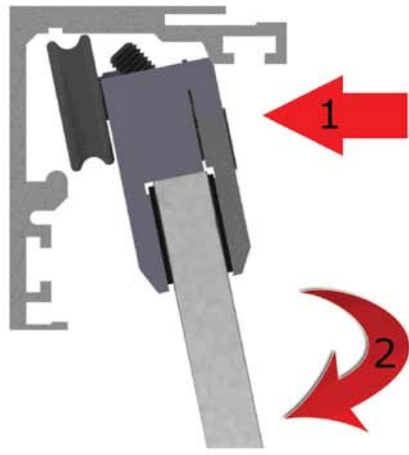

Adjust the height of the door by holding the **RED** nut with a spanner and rotate the **BLUE** grub screw with an allen key

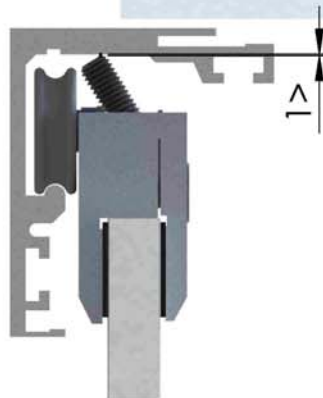
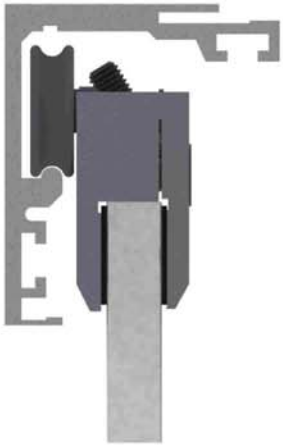

To prevent the hanger from rattling in the track tighten grub screw and leave a 1mm gap or smaller. Try not to obstruct the movement of the hangers.

**Step 6** Install the bottom guide

Ensure the door is level, mark the position of the guide and secure it with screws

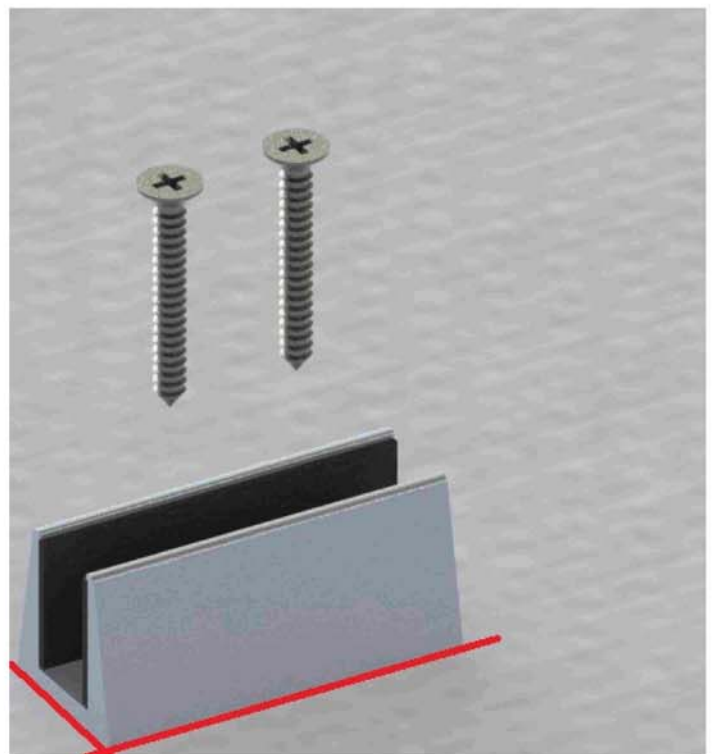
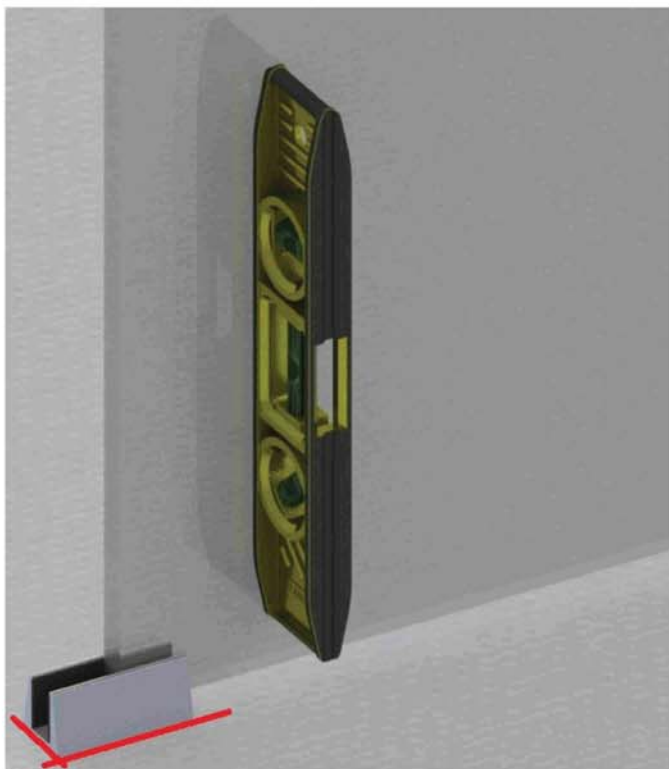

**Step 7** Installing stopper and fitting end caps

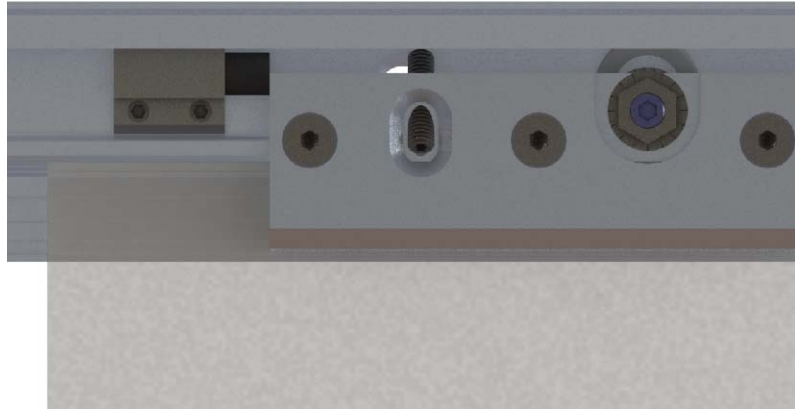

Insert stopper into track and secure it with screws

NOTE: If you opted for a soft closer or syncro kit also refer to the appropriate instructions

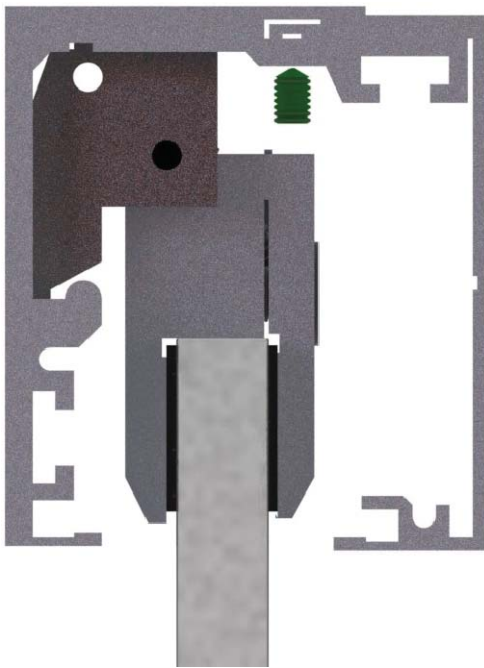

Put the track front cover and secure with screws supplied

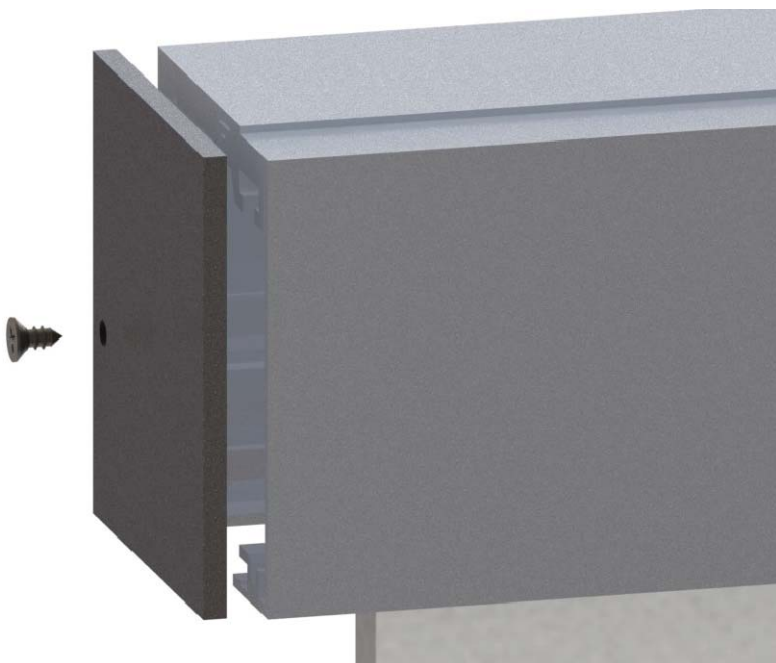

Put end caps into position and secure with screws

# FLEXIGLAS 120



Coburn Sliding Systems Limited

Unit 1, Cardinal West, Cardinal Way,

Godmanchester, PE29 2XN, United Kingdom

Phone: +44 (0)20 8545 6680

Fax: +44 (0)20 8545 6720

E-mail: [sales@coburn.co.uk](mailto:sales@coburn.co.uk)

[www.coburn.co.uk](http://www.coburn.co.uk)