

TWIN-FOLD FIXING DETAILS

SfB(30)

UDC 682 5/6

FOR DOORS BETWEEN 19mm TO 35mm THICK

MAXIMUM WEIGHT 14kg (30lbs) PER DOOR

DOORS UP TO 25mm THICK, MAXIMUM HEIGHT 1.68m

DOORS 25mm TO 35mm THICK, MAXIMUM HEIGHT 1.68m

RECOMMENDED MAXIMUM DOOR WIDTH 458mm.

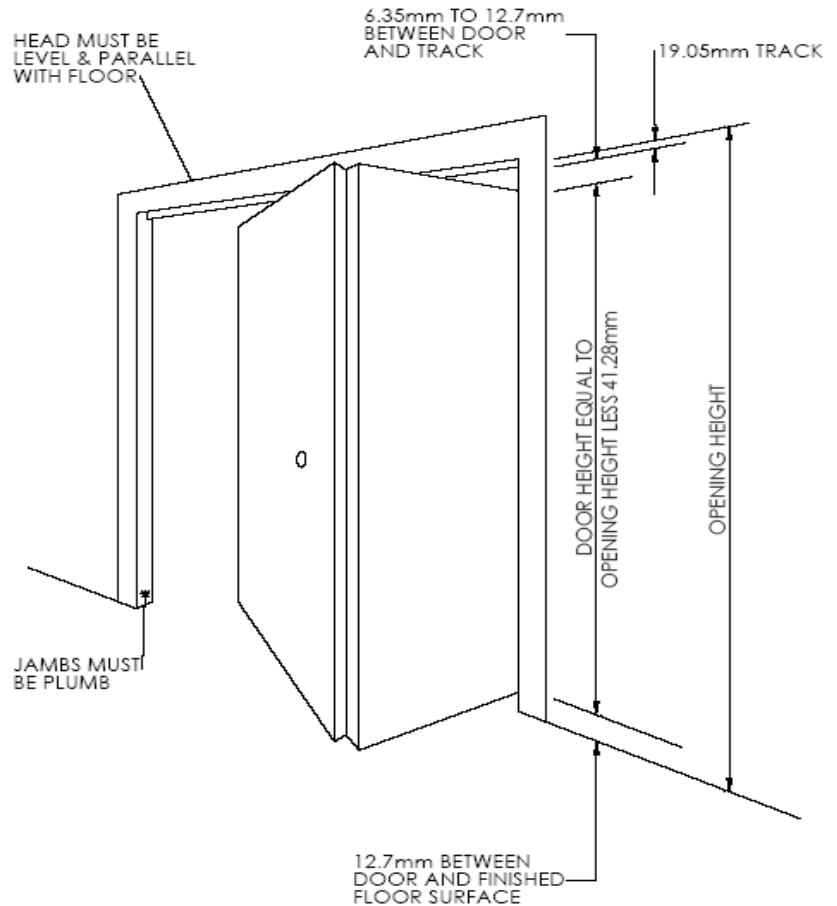

TO ENSURE EASE OF ASSEMBLY AND SMOOTH OPERATION THE JAMBS MUST BE SQUARE AND PLUMB. AND THE HEAD PARALLEL AND LEVEL WITH FLOOR.

TO CALCULATE DOOR WIDTHS

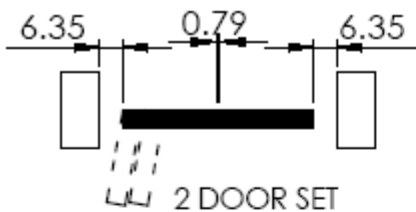

DIVIDE WIDTH OF OPENING BY 2 AND SUBTRACT 6.35mm
EXAMPLE FOR A 838mm OPENING
WIDTH OF EACH DOOR = 412.75mm

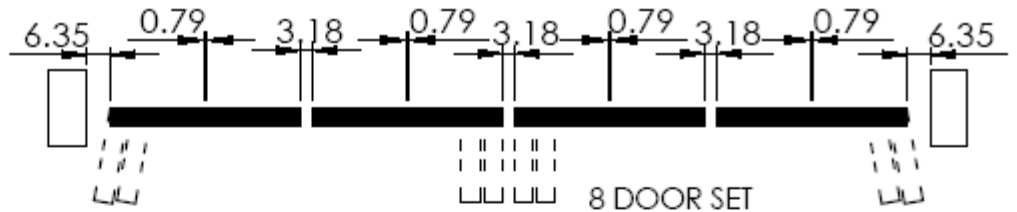

DIVIDE WIDTH OF OPENING BY 8 AND SUBTRACT 3.18mm
EXAMPLE, FOR A 3758mm OPENING
WIDTH OF EACH DOOR = 454mm

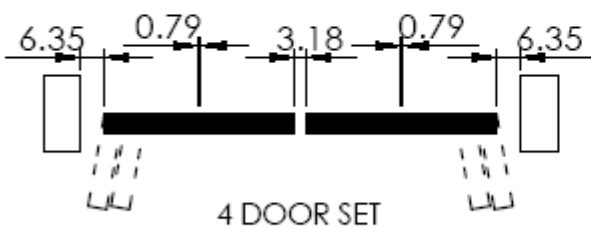

DIVIDE WIDTH OF OPENING BY 4 AND SUBTRACT 4.76mm
EXAMPLE FOR A 1829mm OPENING
WIDTH OF EACH DOOR = 452.44mm

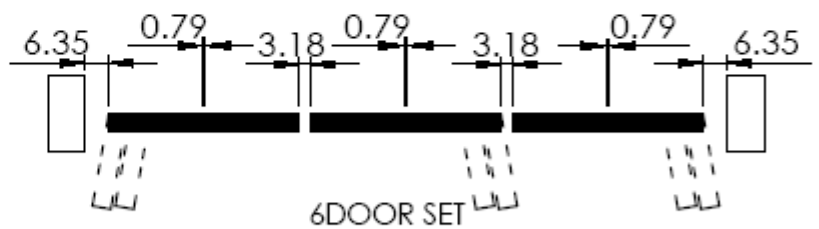

DIVIDE WIDTH OF OPENING BY 6 AND SUBTRACT 3.18mm
EXAMPLE FOR A 2286mm OPENING
WIDTH OF EACH DOOR = 377.83mm

STEP 1

IF REQUIRED CUT TRACK TO SUIT OPENING WIDTH IT MAY BE NECESSARY TO DRILL A FURTHER SCREW HOLE. WHEN USING MORE THAN ONE LENGTH OF TRACK ENSURE THAT ROLLER GUIDES DO NOT PASS OVER JOINTS.

ENTER TOP PIVOT SLIDE INTO TRACK WITH ADJUSTMENT SCREW ON JAMB SIDE OF PIVOT SOCKET.

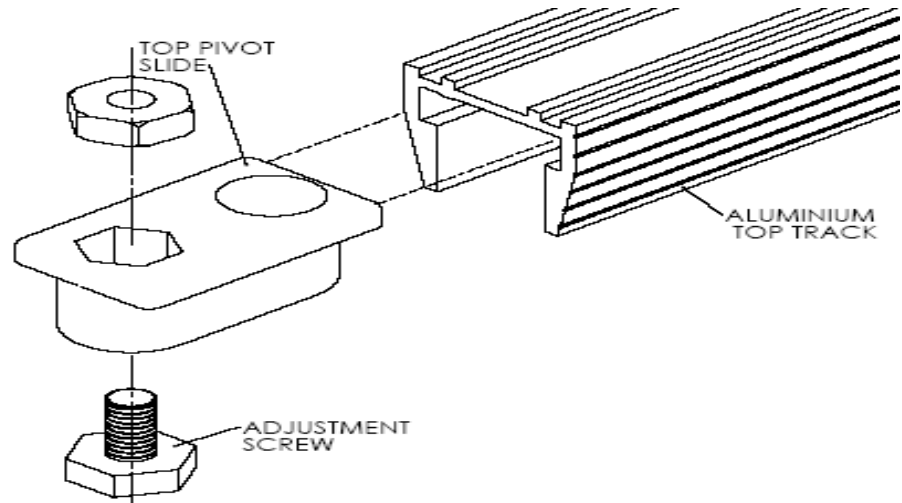

STEP 2

SCREW TRACK INTO POSITION WITH DECORATIVE OR PLAIN SIDE OUTWARDS AS PREFERRED.

USE No. 8 x 19mm COUNTERSUNK WOOD SCREWS. IT IS RECOMEMENED THAT A TIMBER HEAD IS FITTED TO ENSURE THAT THE TRACK IS LEVEL.

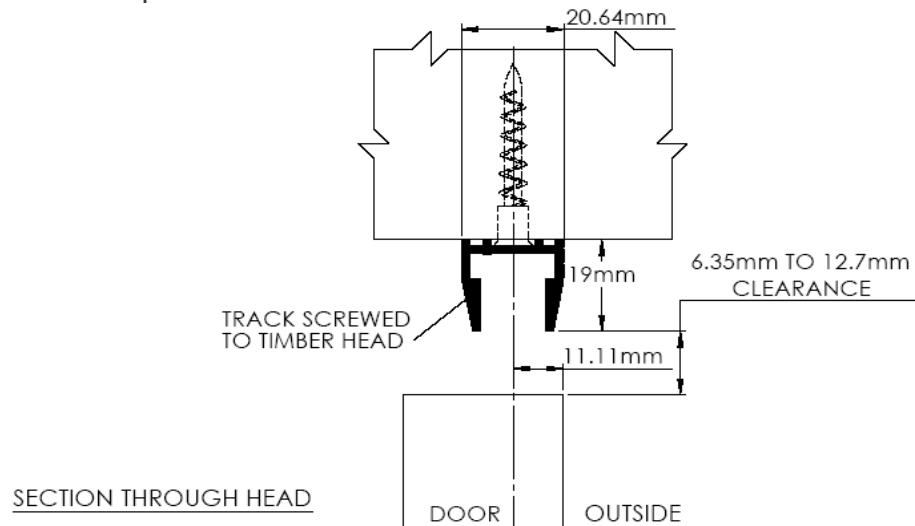

STEP 3

POSITION TOP PIVOT SLIDE IN TRACK WITH CENTRE LINE OF SOCKET 38.1mm IN FROM JAMB AND TEMPORARILY TIGHTEN ADJUSTMENT SCREW. FIX BOTTOM PIVOT HOUSING WITH CENTRE LINE OF PIVOT SOCKET PLUMB WITH CENTER LINE OF TOP PIVOT SOCKET. WITH 6 OR 8 DOOR INSTALLATIONS THE VERTICAL LEGS OF THE INTERMEDIATE AND CENTRE HOUSINGS MUST BE REMOVED. WHEN FIXING HOUSINGS TO MATERIAL OTHER THAN TIMBER, DRILL AND PLUG HOLES AND USE No. 8 x 31.8mm COUNTERSUNK SCREWS IN PLACE OF SCREWS SUPPLIED IN SET.

PIVOT SLIDE REMOVED TO ENABLE SCREWS TO BE FITTED

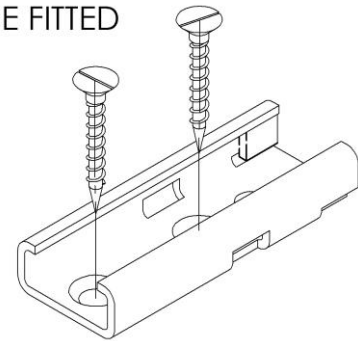

FLOOR FIXING FOR BOTTOM PIVOT HOUSING

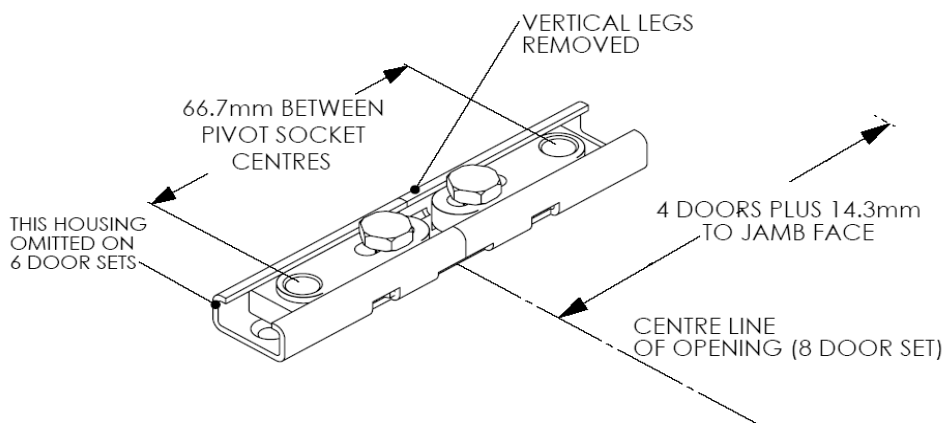

POSITION OF CENTRE & INTERMEDIATE BOTTOM PIVOT HOUSING - OMIT 1 HOUSING ON 6 DOOR SETS

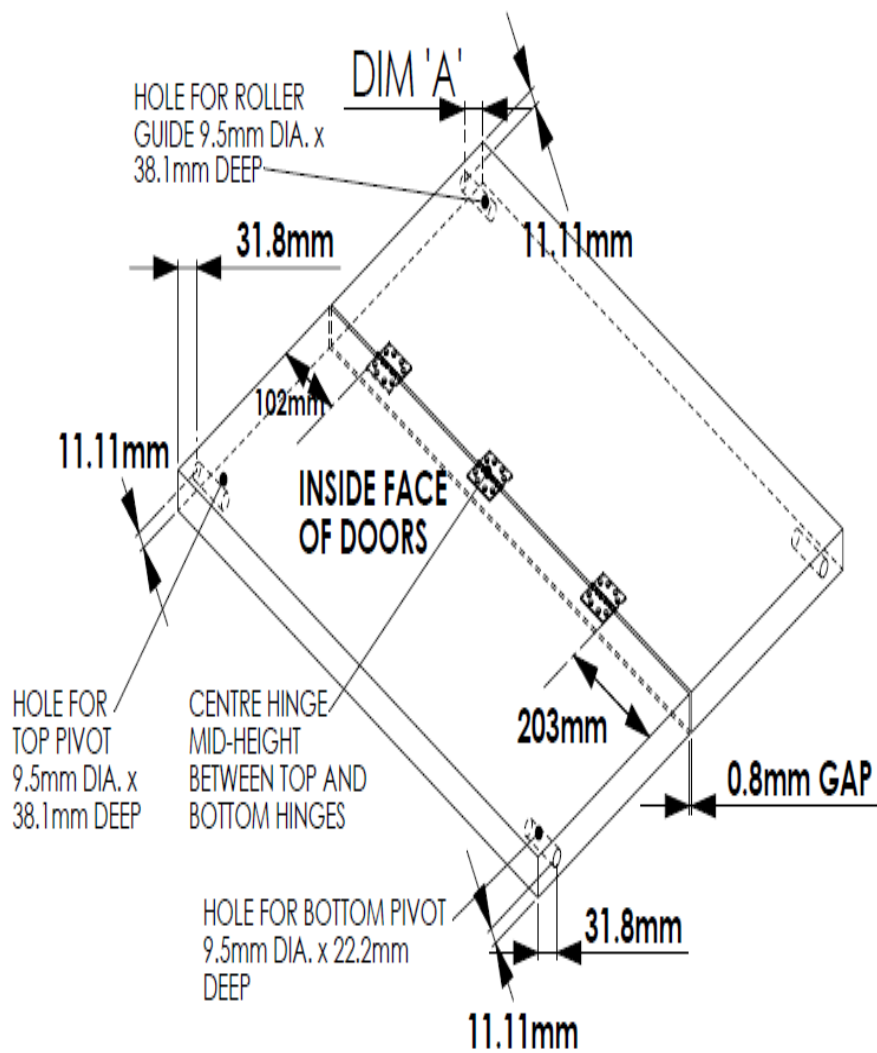

STEP 4

PLACE DOORS OUTSIDE FACE DOWNWARDS AND SCREW HINGES INTO POSITION USING No. 8 x 19mm COUNTERSUNK SCREWS. NOTE; 0.8mm GAP BETWEEN DOORS.

DRILL HOLES FOR TOP AND BOTTOM PIVOTS, ROLLER GUIDE AND HANDLE AS SHOWN.

DIMENSION 'A'

FOR DOORS UP TO 25.4mm THICK

DIMENSION 'A' = 25.4mm

FOR DOORS UP TO 25.4mm TO 35mm THICK

DIMENSION 'A' = 20.6mm

STEP 5

PLACE FITTINGS IN TO POSITION AND SECURE WITH 38mm DRIVE SCREW.

HOLD DOORS TOGETHER AND BY TILTING THEM, ENTER ROLLER GUIDE INTO TRACK AND TOP PIVOT INTO TOP PIVOT SOCKET SLIDE. LIFT DOORS AND PLACE BOTTOM PIVOT INTO BOTTOM PIVOT SLIDE AND HOUSING.

CUT RUBBER BUFFER TO SIZE AND POSITION IN TRACK TO ENGAGE WITH ROLLER GUIDE AND SNAP DOORS SHUT.

STEP 6

ADJUST DOORS FOR PERFECT ALIGNMENT AND OPERATION. HEIGHT OF DOOR IS CONTROLLED BY NUT ON BOTTOM PIVOT. DOORS MAY BE ALIGNED VERTICALLY BY ADJUSTING POSITION OF TOP AND BOTTOM PIVOT SOCKET SLIDES. USE SCREWDRIVER BLADE THROUGH SLOT IN THE SIDE OF HOUSING TO MOVE PIVOT SOCKET SLIDE.

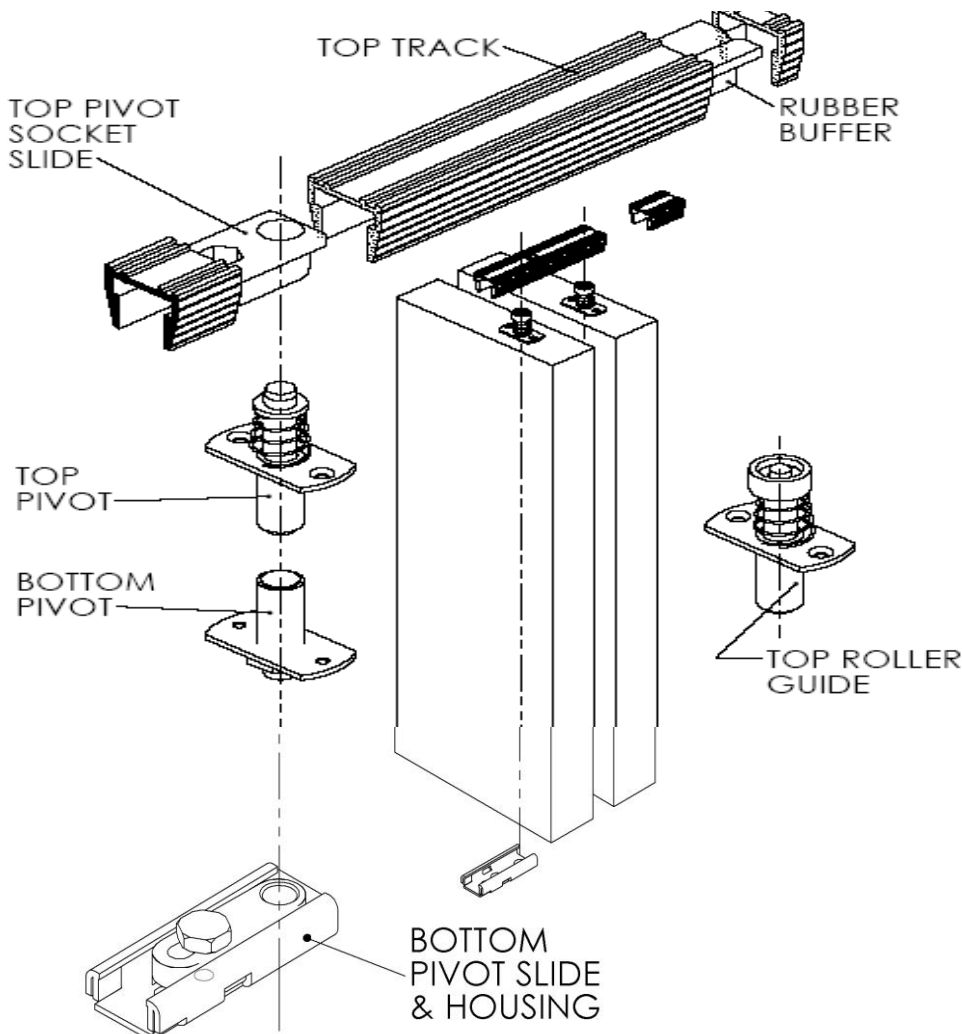

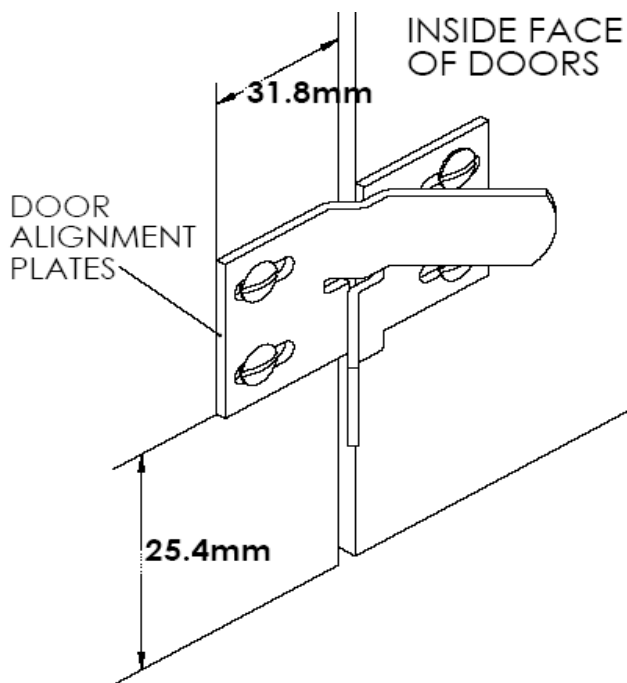
**STEP 7**

ON CENTRE MEETING STILES OF 4 DOOR SETS FIX DOOR ALIGNMENT PLATES TO INSIDE FACE OF DOOR. USE No. 8 x 19mm ROUND-HEAD SCREWS.

THE PLATES SHOULD BE POSITIONED SO THAT THE DOORS ARE HELD FLAT WHEN CLOSED.

FINALLY CHECK THAT THE ADJUSTMENT SCREWS ON TOP AND BOTTOM PIVOTS ARE SECURELY TIGHTENED.

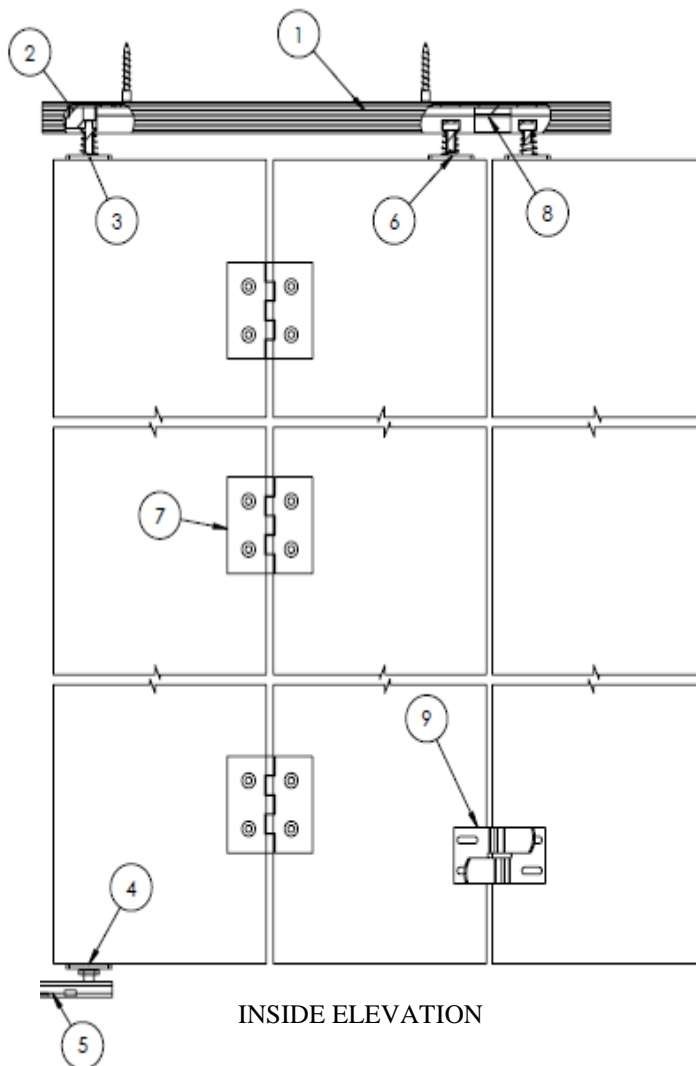
CONTENTS OF SET

ITEM No.	DESCRIPTION	QUANTITY	
		2 DOOR SET	4 DOOR SET
1	ALUMINIUM TOP TRACK	TF 36/2 914mm	TF 60/4 762mm
2	TOP PIVOT SLIDE	1	2
3	TOP PIVOT	1	2
4	BOTTOM PIVOT	1	2
5	BOTTOM PIVOT HOUSING	1	2
6	ROLLER GUIDE	1	2
7	HINGE	3	6
8	RUBBER BUFFER	1	2
9	ALIGNMENT PLATE	1	2
10	SPANNER	1	1

SCHEDULE OF SCREWS

DESCRIPTION	FOR USE WITH	QUANTITY	
		2 DOOR SET	4 DOOR SET
No. 8 x 19mm C/SK WOODSCREWS	TRACK, HINGES & PIVOT HOUSING	20	40
No. 4 x 38mm C/SK DRIVE SCREW	TOP & BOTTOM PIVOT & ROLLER GUIDE	6	12
No. 8 x 19mm ROUND HEAD WOODSCREW	DOOR ALIGNMENT PLATE	2	4