

# GLASSMASTER TEC

**COBURN**  
GLASS SYSTEMS

Stainless steel sliding  
door systems

GLASSMASTER TEC





# GLASSMASTER TEC

Stainless steel sliding door systems

Sliding doors made from glass and wood can be both functional and elegant and lend rooms a special flair.

Visible technology and high-grade craftsmanship set new boundaries in room design. All products are characterised by their solid construction, easy use and very quiet movement. There are 5 sliding door systems for glass and wood doors available to satisfy your design needs: Flatec I, Flatec II, Unotec, Duetec and Tritec.

You can choose complete sets or individually plan your sliding door system. We can supply a large selection of door handles and flush pulls.



Tritec Glass



Flatec I Wood

## Contents:

### Sliding door fittings

Sets for glass doors Flatec I, Unotec Home, Unotec Objekt, Duetec, Tritec	4 – 8
Sets for wooden doors Flatec I, Flatec II, Unotec Home, Tritec	9 – 12
Planning guide (extract)	13 -15
System components	16 – 21
Track	16
Wall Mountings	16 – 17
Mounting on glass	18
Hangers	19 - 20
Accessories	21 - 23
Door stops, Bottom guides	21
Door handles, Flush pulls	22 - 23

## Key:

- i** Important information
- !** Processing instructions
- ?** References to additional products

All stainless steel products come with a finely ground (brushed) stainless steel surface.

All dimensions in mm

## Flatec I glass



**Complete-sets, standard model** d = 8 -12 mm,  
height-adjustable approx. 7 mm, consisting of:

- 1 Track, solid stainless steel, Ø 25 mm, 57330  
length: see table
- 3 - 4 Wall attachments, stainless steel, 57523, with  
anchor screws M8 x 70 mm
- 2 Hangers Flatec I glass, stainless steel, 57541
- 2 Door stop, stainless steel, 57539
- 1 Bottom guide, stainless steel, 57550
- 1 Special tool for decorative screws, 57535
- 1 Installation instructions

Set numbers	Guide rail length mm	Passage width mm
57201	1800	750-900
57202	2100	910-1000
57203	2300	1010-1120
57204	2540	1130-1250

**!** Glass drill holes Ø 12 mm + 0,3 mm

The maximum door weight is 100 kg

For baseboards and trimmings, order spacer, (stainless steel, 57511) separately for each wall attachment , see planning guide or page 13

**?** For special lengths for guide rails, other individual componets and accessories, refer to page 16 .

NOTE: Above sets are supplied with track fixing brackets for wall fixing. If fixing track to a glass panel, please ask for advice.

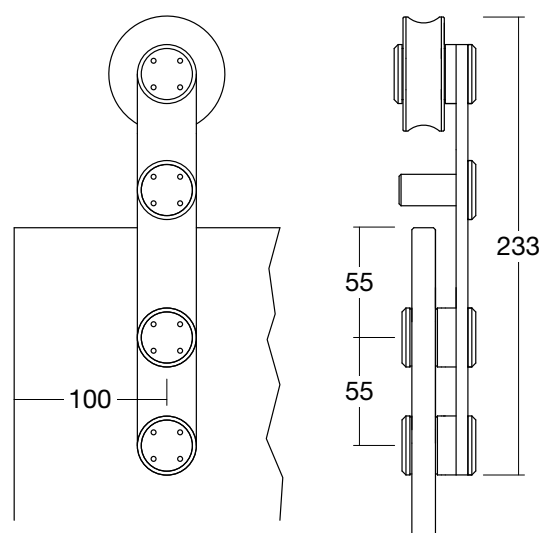

## Unitec Home glass

**Complete-sets, standard model** d = 8 -12 mm,  
consisting of:

- 1 Track, solid stainless steel, Ø 25 mm, 57330  
length: see table
- 3 - 4 Wall attachments, stainless steel, 57523, with  
anchor screws M8 x 70 mm
- 2 Hangers Unotec Home glass, stainless steel, 57544
- 2 Door stop, stainless steel, 57538
- 1 Bottom guide, stainless steel, 57550
- 1 Special tool for decorative screws, 57535
- 1 Installation instructions

Set numbers	Guide rail length mm	Passage width mm
57211	1800	750-900
57212	2100	910-1000
57213	2300	1010-1120
57214	2540	1130-1250

**!** Glass drill holes Ø 12 mm + 0,3 mm

The maximum door weight is 100 kg

For baseboards and trimmings, order spacer, (stainless steel, 57511) separately for each wall attachment , see planning guide or page 13

**?** For special lengths for guide rails, other individual componets and accessories, refer to page 16

NOTE: Above sets are supplied with track fixing brackets for wall fixing. If fixing track to a glass panel, please ask for advice.

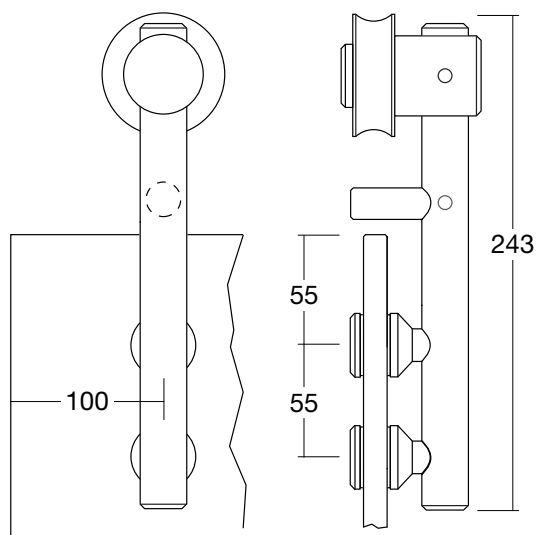

## Unotec Objekt glass



**Complete-sets, standard model** d = 8 -12 mm,  
height-adjustable approx. 15 mm, consisting of:

- 1 Track, solid stainless steel, Ø 25 mm, 57330  
length: see table
- 3 - 4 Wall attachments, stainless steel, 57523, with  
anchor screws M8 x 70 mm
- 2 Hangers Unotec Objekt glass, stainless steel, 57546
- 2 Door stop, stainless steel, 57538
- 1 Bottom guide, stainless steel, 57550
- 1 Special tool for decorative screws, 57535
- 1 Installation instructions

Set numbers	Guide rail length mm	Passage width mm
57221	1800	750-900
57222	2100	910-1000
57223	2300	1010-1120
57224	2540	1130-1250

**!** Glass drill holes Ø 12 mm + 0,3 mm

The maximum door weight is 100 kg

For baseboards and trimmings, order spacer, (stainless steel, 57511) separately for each wall attachment, see planning guide or page 13.

**?** For special lengths for guide rails, other individual componets and accessories, refer to page 16.

NOTE: Above sets are supplied with track fixing brackets for wall fixing. If fixing track to a glass panel, please ask for advice.

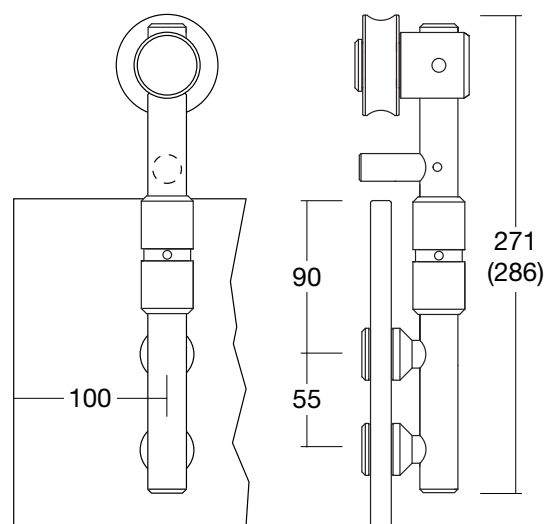



## Duetec glass

**Complete-sets, standard model** d = 8 - 10 mm  
height-adjustable approx. 7 mm, consisting of:

- 1 Guide rail, solid stainless steel, Ø 25 mm, 57330  
length: see table
- 3 - 4 Wall attachments, stainless steel, 57523, with  
anchor screws M8 x 70 mm
- 2 Hangers Duetec glass, stainless steel, 57547
- 2 Door stopper, stainless steel, 57539
- 1 Bottom guide, stainless steel, 57550
- 1 Special tool for decorative screws, 57535
- 1 Installation instructions

Set numbers	Guide rail length mm	Passage width mm
57231	1800	750-900
57232	2100	910-1000
57233	2300	1010-1120
57234	2540	1130-1250

**!** Glass drill holes Ø 12 mm + 0,3 mm

The maximum door weight is **60 kg**

For baseboards and trimmings, order spacer, (stainless steel, 57511) separately for each wall attachment, see planning guide or page 13.

**?** For special lengths for guide rails, other individual componets and accessories, refer to page 16.

NOTE: Above sets are supplied with track fixing brackets for wall fixing. If fixing track to a glass panel, please ask for advice.

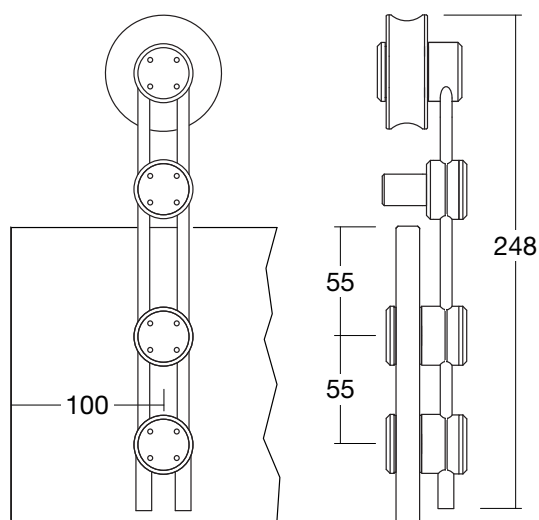



## Tritec glass



**Complete-sets, standard model** d = 8 -12 mm, height-adjustable approx. 7 mm, consisting of:

- 1 Track, solid stainless steel,  $\varnothing$  25 mm, 57330 length: see table
- 3 - 4 Wall attachments, stainless steel, 57523, with anchor screws M8 x 70 mm
- 2 Hangers Tritec glass, stainless steel, 57548
- 2 Door stop, stainless steel, 57539
- 1 Bottom guide, stainless steel, 57550
- 1 Special tool for decorative screws, 57535
- 1 Installation instructions

Set numbers	Guide rail length mm	Passage width mm
57241	1800	750-900
57242	2100	910-1000
57243	2300	1010-1120
57244	2540	1130-1250

**!** Glass drill holes  $\varnothing$  12 mm + 0,3 mm

The maximum door weight is 100 kg

For baseboards and trimmings, order spacer, (stainless steel, 57511) separately for each wall attachment, see planning guide or page 13.

**?** For special lengths for guide rails, other individual componets and accessories, refer to page 16.

NOTE: Above sets are supplied with track fixing brackets for wall fixing. If fixing track to a glass panel, please ask for advice.

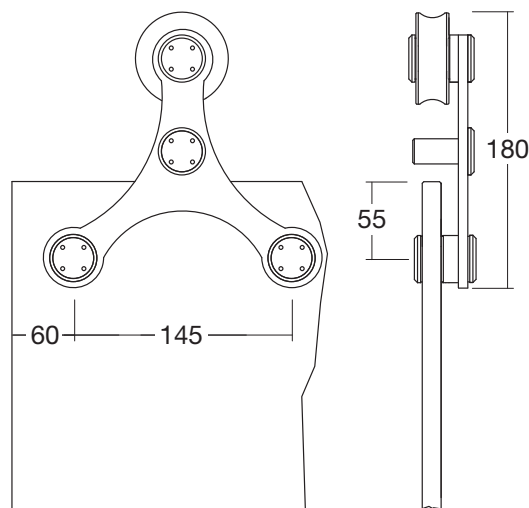

## Flatec I wood

**Complete-sets, standard model**  $d \leq 40$  mm,  
height-adjustable approx. 7 mm, consisting of:

- 1 Track, solid stainless steel,  $\varnothing$  25 mm, 57330  
length: see table
- 3 - 4 Wall attachments, stainless steel, 57524, with  
anchor screws M8 x 90 mm
- 2 Hangers Flatec I wood, stainless steel, 57542
- 2 Door stop, stainless steel, 57539
- 1 Bottom guide, plastic, 57551
- 1 Special tool for decorative screws, 57535
- 1 Installation instructions

Set numbers	Guide rail length mm	Passage width mm
57251	1800	750-900
57252	2100	910-1000
57253	2300	1010-1120
57254	2540	1130-1250

**!** Wood drill holes  $\varnothing$  10 mm + 0,3 mm

The maximum door weight is 100 kg

For baseboards and trimmings, order spacer, (stainless steel, 57512) separately for each wall attachment, see planning guide or page 13.

**?** For special lengths for guide rails, other individual componets and accessories, refer to page 16.

NOTE: Above sets are supplied with track fixing brackets for wall fixing. If fixing track to a glass panel, please ask for advice.

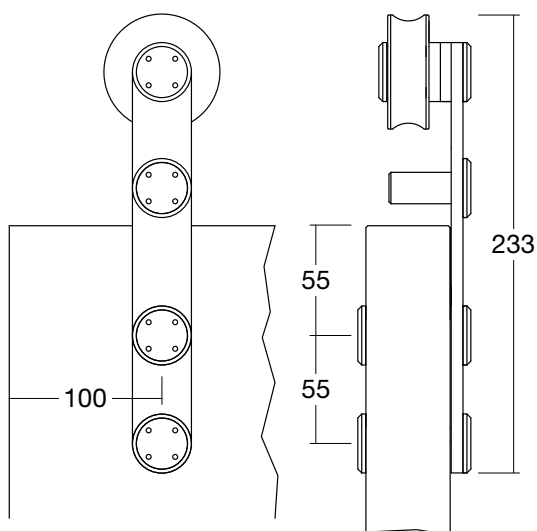

## Flatec II wood



**Complete-sets, standard model**  $d \leq 40$  mm,  
consisting of:

- 1 Track, solid stainless steel,  $\varnothing$  25 mm, 57330  
length: see table
- 3 - 4 Wall attachments, stainless steel, 57524, with  
anchor screws M8 x 90 mm
- 2 Hangers Flatec II wood, stainless steel, 57543
- 2 Door stop, stainless steel, 57539
- 1 Bottom guide, plastic, 57551
- 1 Special tool for decorative screws, 57535
- 1 Installation instructions

Set numbers	Guide rail length mm	Passage width mm
57261	1800	750-900
57262	2100	910-1000
57263	2300	1010-1120
57264	2540	1130-1250

**!** Wood drill holes  $\varnothing$  10 mm + 0,3 mm

The maximum door weight is 100 kg

For baseboards and trimmings, order spacer, (stainless steel, 57512) separately for each wall attachment, see planning guide or page 13.

**?** For special lengths for guide rails, other individual componets and accessories, refer to page 16.

NOTE: Above sets are supplied with track fixing brackets for wall fixing. If fixing track to a glass panel, please ask for advice.

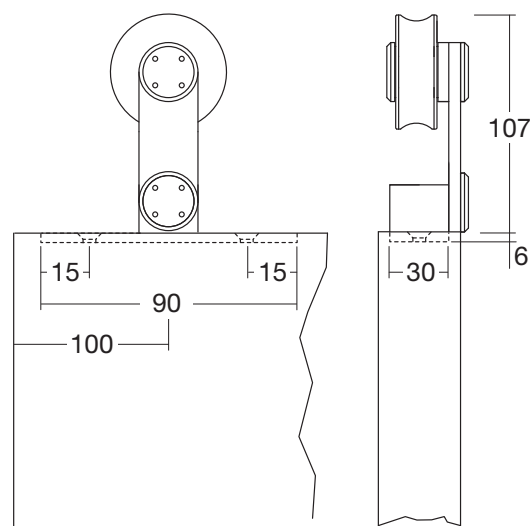

## Unotec Home wood

**Complete-sets, standard model**  $d \leq 40$  mm,  
consisting of:

- 1 Guide rail, solid stainless steel,  $\varnothing$  25 mm, 57330  
length: see table
- 3 - 4 Wall attachments, stainless steel, 57524, with  
anchor screws M8 x 90 mm
- 2 Hangers Unotec Home wood, stainless steel, 57545
- 2 Door stop, stainless steel, 57538
- 1 Bottom guide, plastic, 57551
- 1 Special tool for decorative screws, 57535
- 1 Installation instructions

Set numbers	Guide rail length mm	Passage width mm
57271	1800	750-900
57272	2100	910-1000
57273	2300	1010-1120
57274	2540	1130-1250

**!** Wood drill holes  $\varnothing$  10 mm + 0,3 mm

The maximum door weight is 100 kg

For baseboards and trimmings, order spacer, (stainless steel, 57512) separately for each wall attachment, see planning guide or page 13.

**?** For special lengths for guide rails, other individual componets and accessories, refer to page 16.

NOTE: Above sets are supplied with track fixing brackets for wall fixing. If fixing track to a glass panel, please ask for advice.

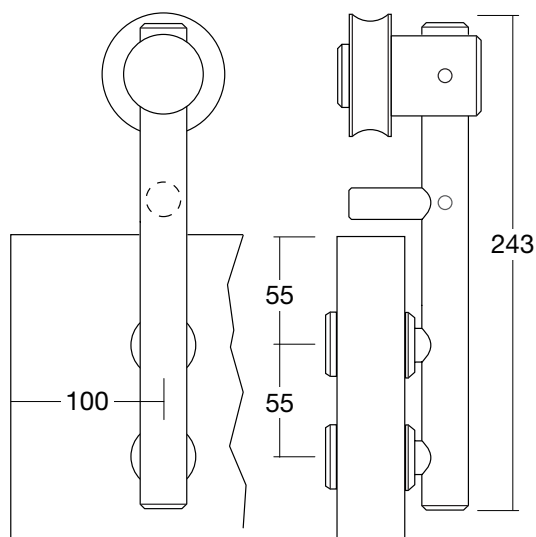

## Tritec wood



**Complete-sets, standard model**  $d \leq 40$  mm, height-adjustable approx. 7 mm, consisting of:

- 1 Track, solid stainless steel,  $\varnothing$  25 mm, 57330 length: see table
- 3 - 4 Wall attachments, stainless steel, 57524, with anchor screws M8 x 90 mm
- 2 Hangers Tritec wood, stainless steel, 57549
- 2 Door stop, stainless steel, 57539
- 1 Bottom guide, plastic, 57551
- 1 Special tool for decorative screws, 57535
- 1 Installation instructions

Set numbers	Guide rail length mm	Passage width mm
57281	1800	750-900
57282	2100	910-1000
57283	2300	1010-1120
57284	2540	1130-1250

**!** Wood drill holes  $\varnothing$  10 mm + 0,3 mm

The maximum door weight is 100 kg

For baseboards and trimmings, order spacer, (stainless steel, 57512) separately for each wall attachment, see planning guide or page 13.

**?** For special lengths for guide rails, other individual componets and accessories, refer to page 16.

NOTE: Above sets are supplied with track fixing brackets for wall fixing. If fixing track to a glass panel, please ask for advice.

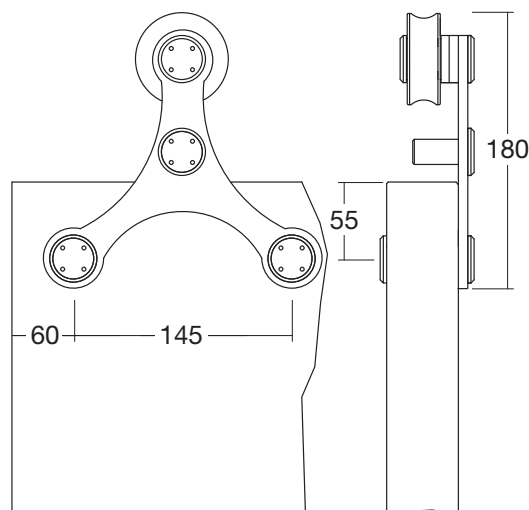



## Planning guide (extract)

- i** We have complete sets as well as single system components available for you to make your individual designs and plans using our sliding door systems. Planning and assembly instructions for all systems can be supplied on request. On the following pages, please have a look at some extracts presented as examples.

mm		Each	Manufacturing dimensions (special model)							kg	Each		
A	B	C	D	D1	E max. 2500	F 7 - 10	G	H max. 2518 (H = E - F + Y)	J	Load-bearing capacity of the guide rail	L	M	N
							(60)				1	2	2

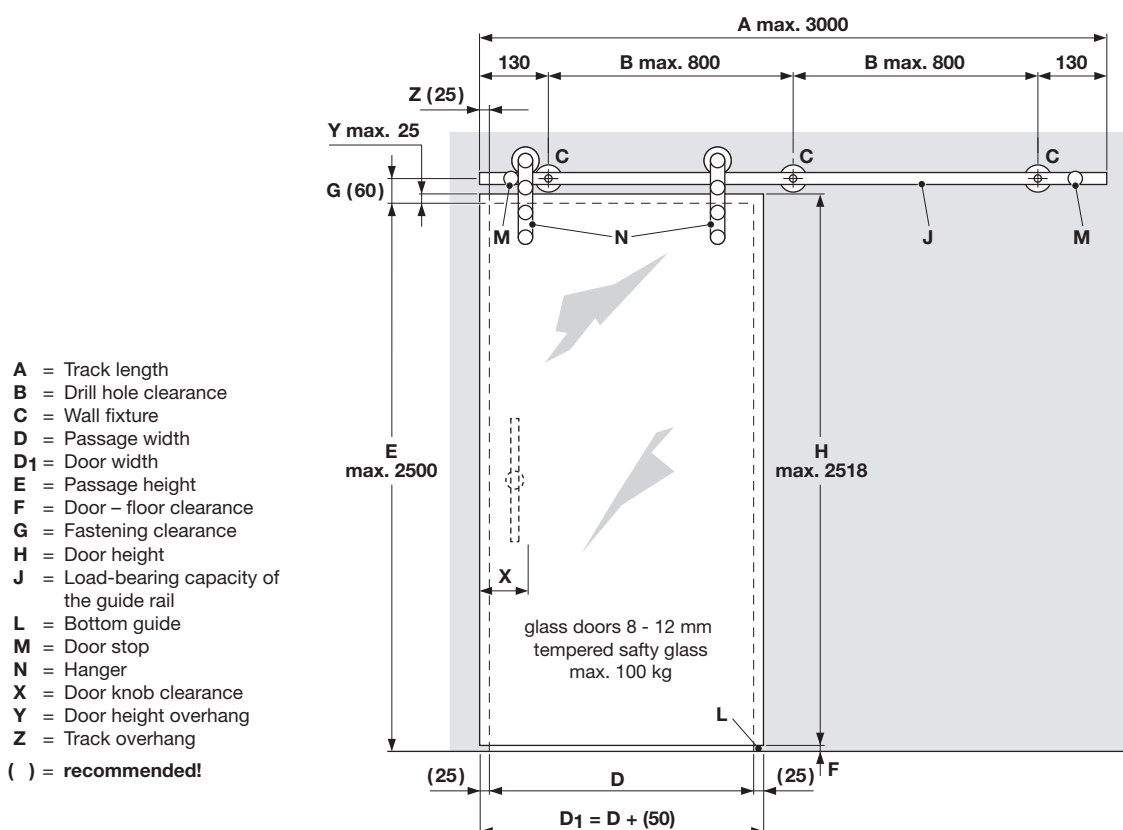

### Calculation for track length A for 1 door

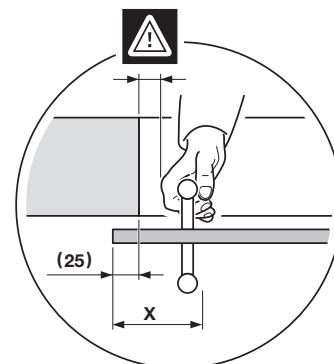
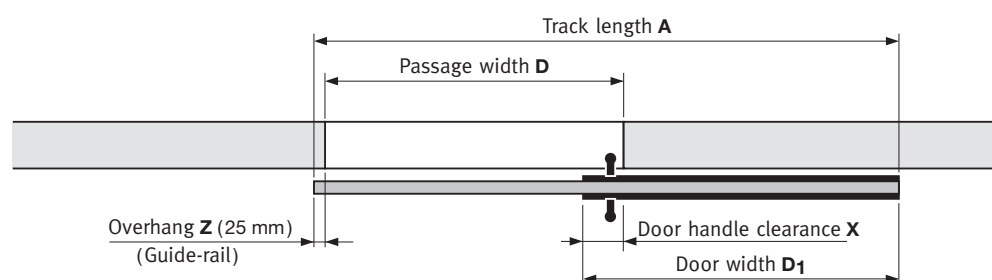

**Overhang Z + Passage width D + Door width D1 - Door handle clearance X = Track length A**  
Make door handle clearance so that fingers do not get pinched when the door is moved

Planning guide (extract)

Manufacturing dimensions (special model)											kg				
A	B1	B2	C	D	D1	D2	E	F	G	H max. 2518 (H = E - F + Y)	Load-bearing capacity of the guide rail J	K	L	M	N
mm	mm	mm	mm	mm	mm	mm	mm	mm	mm	mm	mm	mm	mm	mm	mm
							max. 2500	7 - 10	(60)						
												1	2	4	4

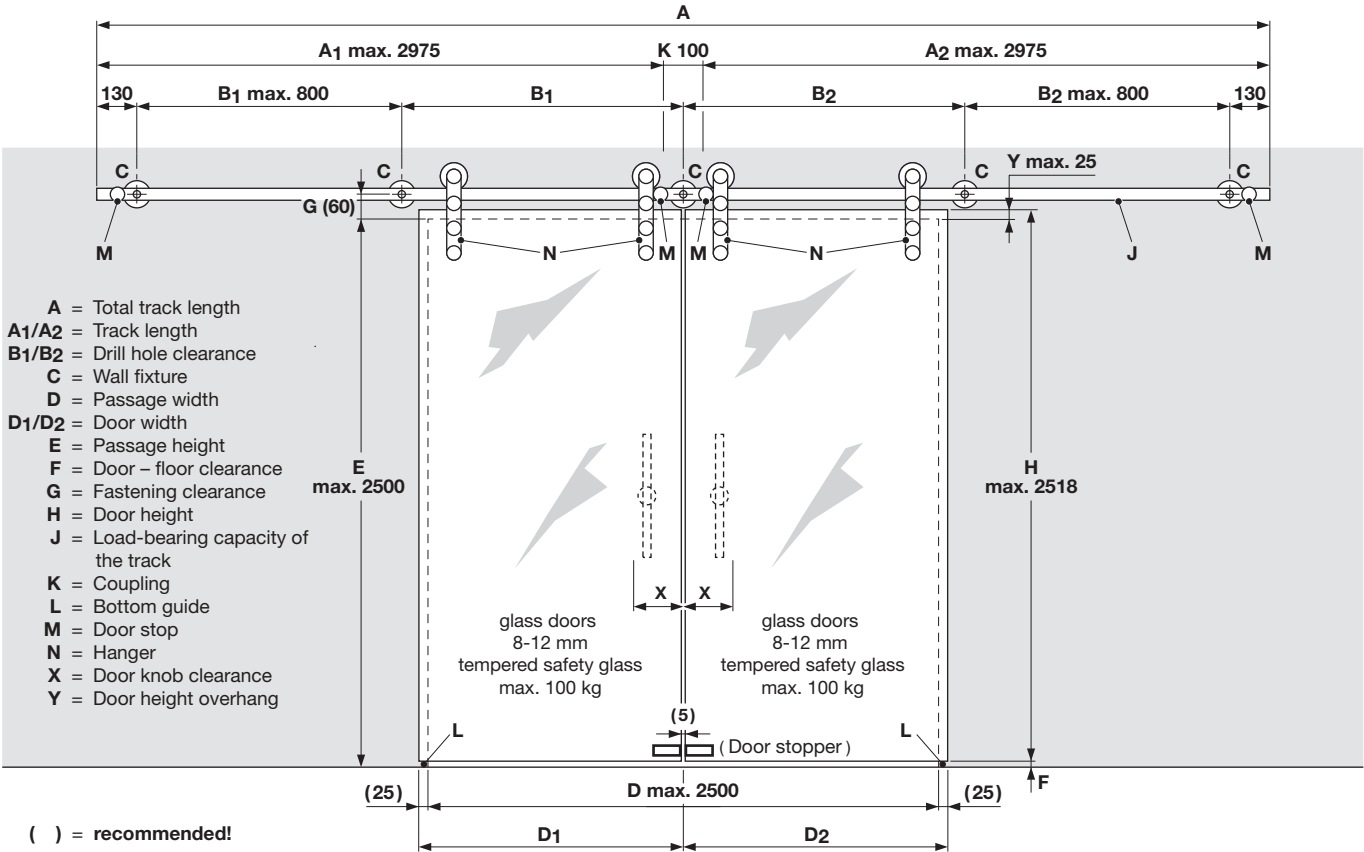

Calculation for total track length A for **2 doors**

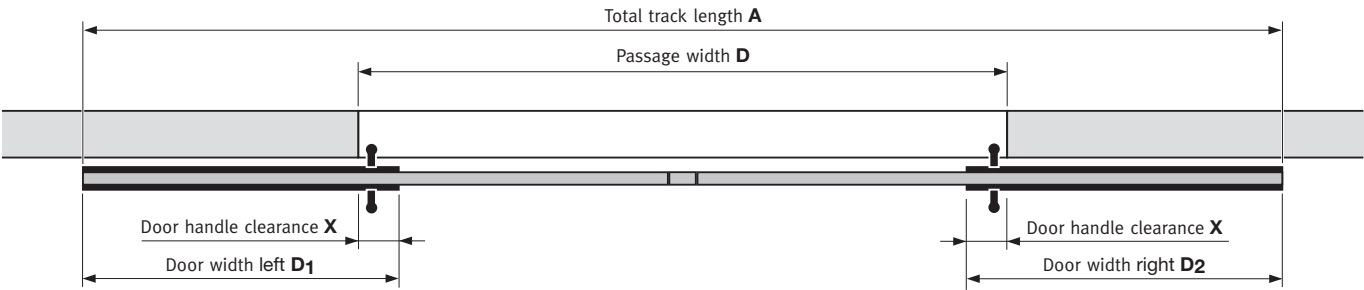

 Make door handle clearance so that fingers do not get pinched when the door is moved See page 13.



Diagram for calculating  
clearance (B)  
in wall fixture (C)  
for track (A)



### Standard installation **glass**

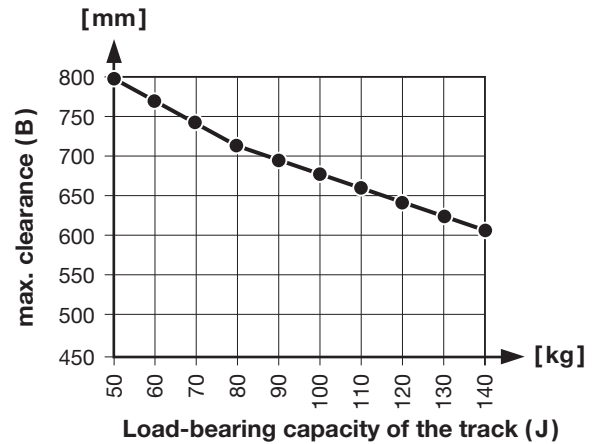
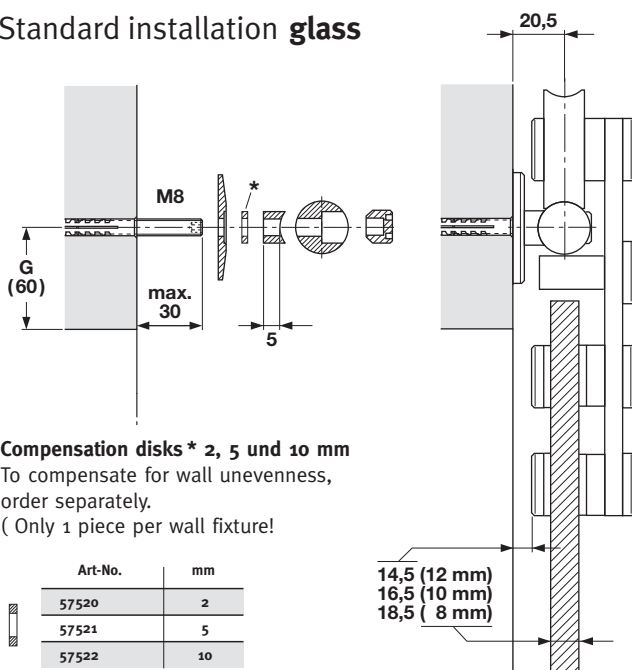

**Compensation disks \* 2, 5 und 10 mm**  
To compensate for wall unevenness,  
order separately.  
( Only 1 piece per wall fixture!)

Art-No.	mm
57520	2
57521	5
57522	10

14,5 (12 mm)  
16,5 (10 mm)  
18,5 ( 8 mm)

### Standard installation **wood**

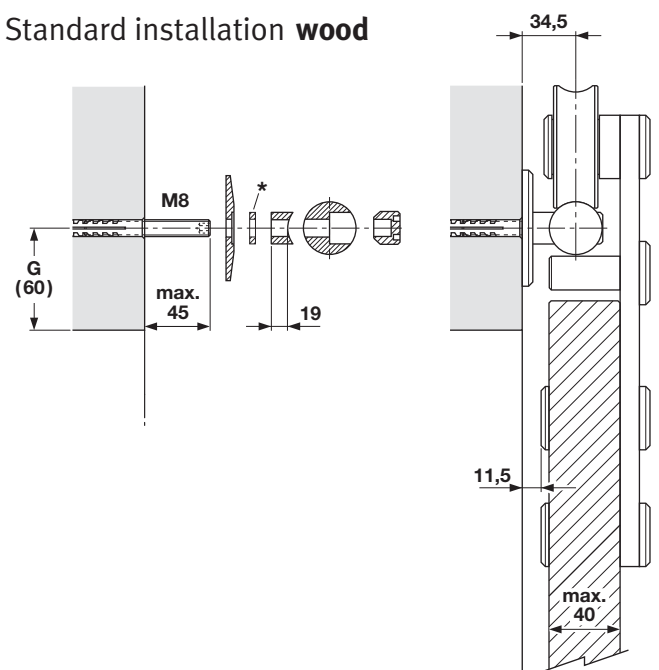

### Installation with baseboards and trim **glass**

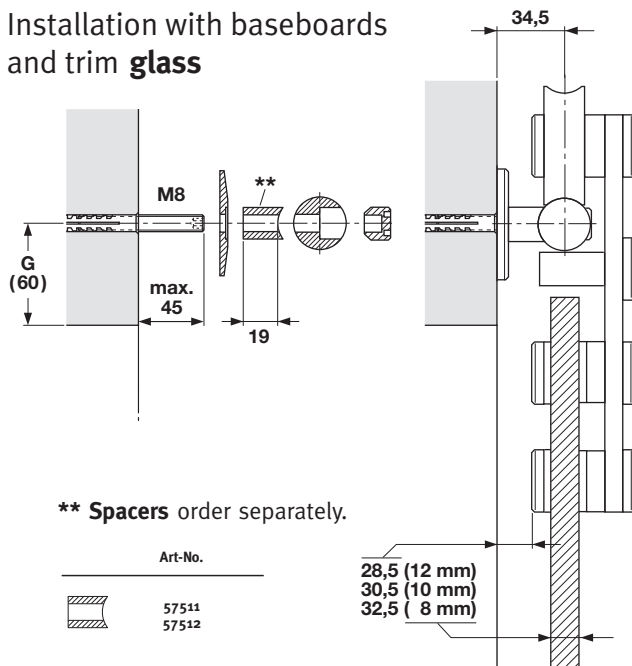

**\*\* Spacers** order separately.

Art-No.	
57511	
57512	

28,5 (12 mm)  
30,5 (10 mm)  
32,5 ( 8 mm)

### Installation with baseboards and trim **wood**

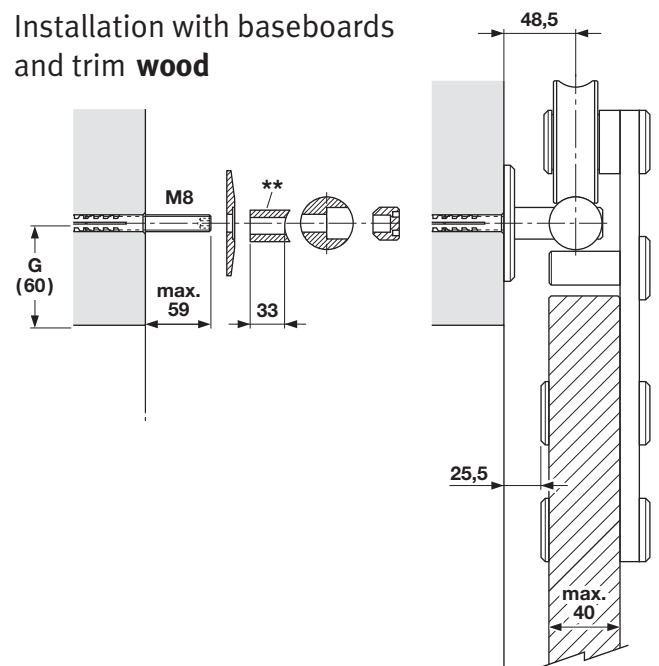

25,5

max.  
40

## System components

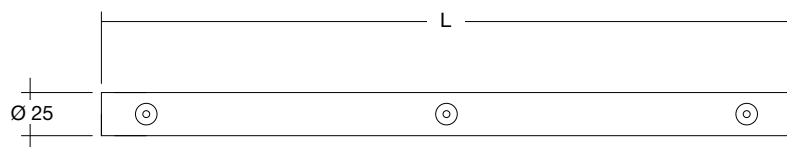

### Track, Wall fixtures

**Cat. No.**  
57330

**Track**  
Stainless steel,  $\varnothing$  25 mm,  
no attachment points,  
please state length!  
 $\leq$  3000 mm as one piece,  
 $\geq$  3000 mm two-parts with  
coupling

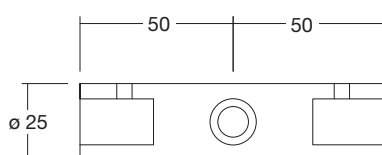

**Cat. No.**  
57515

**Coupling**  
For track 57330,  
stainless steel,  $\varnothing$  25 mm,  
L = 100 mm

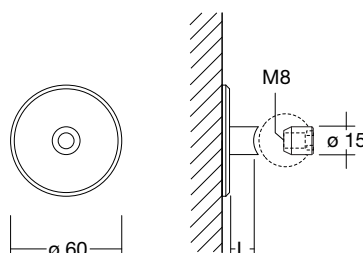

**Cat. No.**  
57523

**Wall fixtures (M8)**  
For glass doors on masonry  
without trim and baseboard,  
stainless steel, distance L = 5 mm,  
disk  $\varnothing$  60 mm,  
with anchor screws M8 x 70 mm

57524

For wood doors on masonry,  
without trim and baseboard,  
stainless steel, distance  
L = 19 mm, disk  $\varnothing$  60 mm,  
with anchor screws M8 x 90 mm

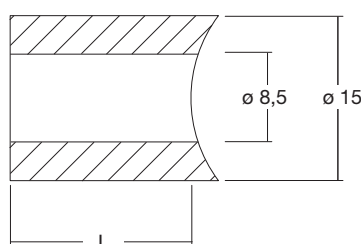

**Cat. No.**  
57511

**Spacer**  
For glass doors with trim  
and baseboard, stainless steel,  
distance L = 19 mm,  $\varnothing$  15 mm

57512

For wood doors with trim  
and baseboard, stainless steel,  
distance L = 33 mm,  $\varnothing$  15 mm

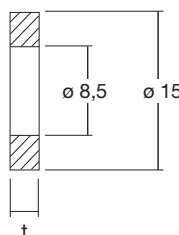

**Cat. No.**  
57520  
57521  
57522

**Compensation disks**  
Thickness = 2 mm  
Thickness = 5 mm  
Thickness = 10 mm  
stainless steel,  $\varnothing$  15 mm,  
to compensate for wall  
unevenness, only one piece per  
wall mount!

**Cat. No.**  
57525

**Wall track, front face**

For track 57330, stainless steel, attachment point can be adjustable using elongated hole

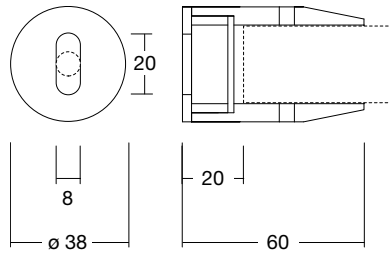

**Cat. No.**  
57526

**Wall fixture, adjustable**

Stainless steel, wall clearance can be adjusted approx. 7 mm, attachment point using elongated hole

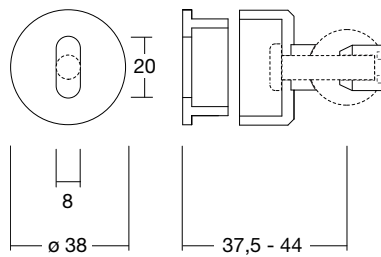

**Cat. No.**  
57527

**Ceiling fixture**

For single track 57330, stainless steel, attachment point can be adjustable using elongated hole

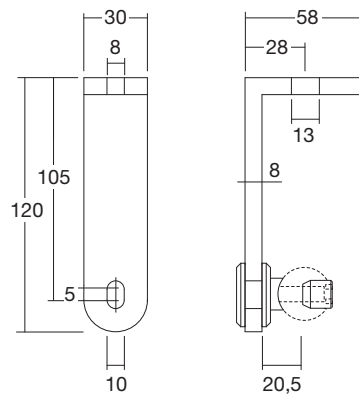

**Cat. No.**  
57528

**Ceiling fixture**

For double track 57330, stainless steel, attachment point can be adjustable using elongated hole

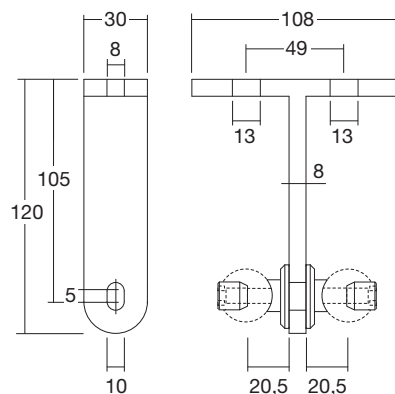

## System components

### Mounting on glass

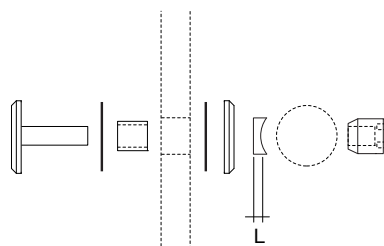

**Cat. No.**  
57530  
57531

#### Glass fastening set Type

For glass doors, distance  $L = 5$  mm  
For wood doors, distance  $L = 19$  mm  
stainless steel,  $\varnothing 30$  mm,  
mounting the track  
on glass surfaces with  
glass protection set

**!** Glass drill holes  $\varnothing 14$  mm + 0,3 mm

57330

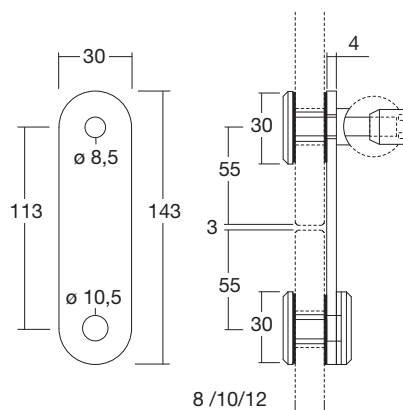

**Cat. No.**  
57532  
57533  
57534

#### Glass joint plate

for continuous skylight of glasses  
For glass surfaces  $d = 8$  mm  
For glass surfaces  $d = 10$  mm  
For glass surfaces  $d = 12$  mm  
stainless steel,  $\varnothing 30$  mm, set for  
mounting glass surfaces,  
Glass drill holes  $\varnothing 14$  mm + 0,3 mm

**!**

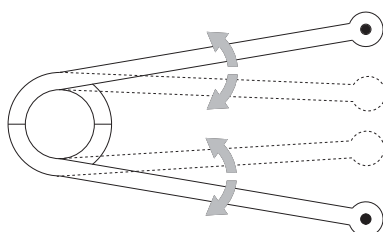

**Cat. No.**  
57535

#### Special tool

For decorative screws (adjustable)

## Trolleys

**Cat. No.**  
57541  
57542

### Hanger, Flatec I

For glass doors,  $d = 8-12 \text{ mm}$   
For wood doors,  $d \leq 40 \text{ mm}$   
stainless steel, height-adjustable  
approx. 7 mm

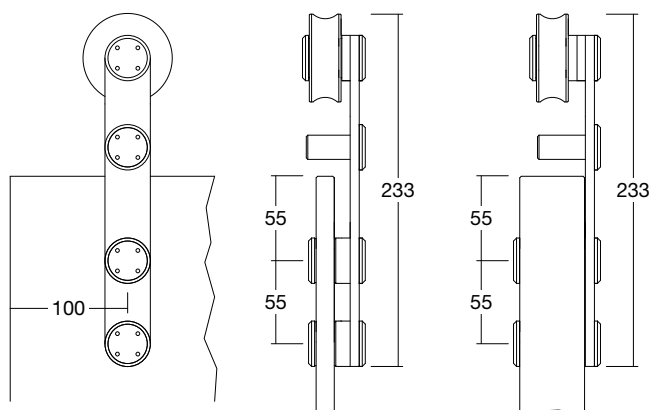

**Cat. No.**  
57543

### Hanger, Flatec II

For glass doors,  $d \leq 40 \text{ mm}$   
stainless steel, without height  
adjustment

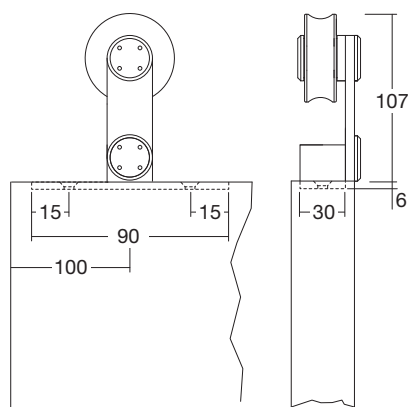

**Cat. No.**  
57544  
57545

### Hanger, Unotec Home

For glass doors,  $d = 8-12 \text{ mm}$   
For wood doors,  $d \leq 40 \text{ mm}$   
stainless steel, without height  
adjustment

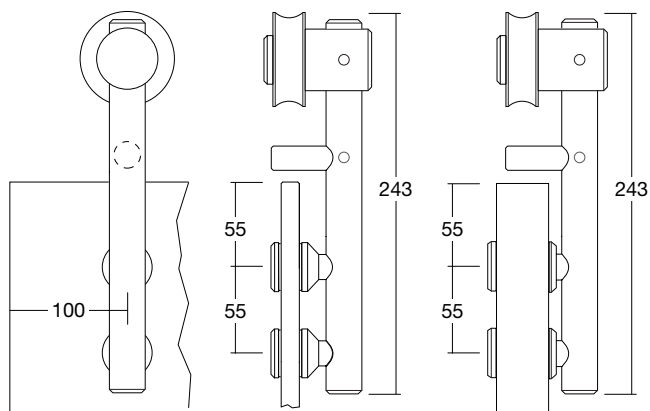

**!** Glass drill holes  $\varnothing 12 \text{ mm} + 0,3 \text{ mm}$   
Wood drill holes  $\varnothing 10 \text{ mm} + 0,3 \text{ mm}$

## System components

### Trolleys

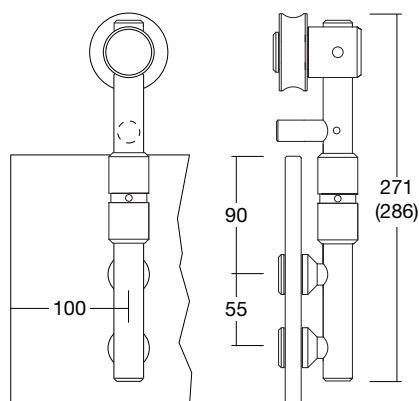

**Cat. No.**  
57546

#### Hanger, Unotec Object

For glass doors,  $d = 8-12$  mm  
stainless steel, height-adjustable  
approx. 15 mm

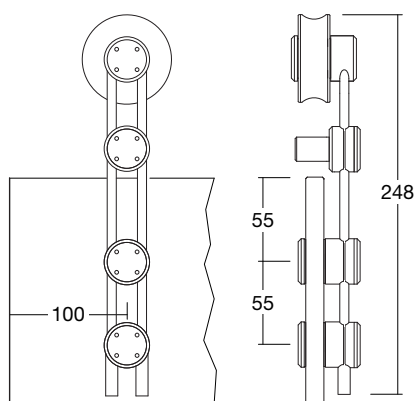

**Cat. No.**  
57547

#### Hanger, Duetec

For glass doors,  $d = 8-10$  mm  
stainless steel, height-adjustable  
approx. 7 mm

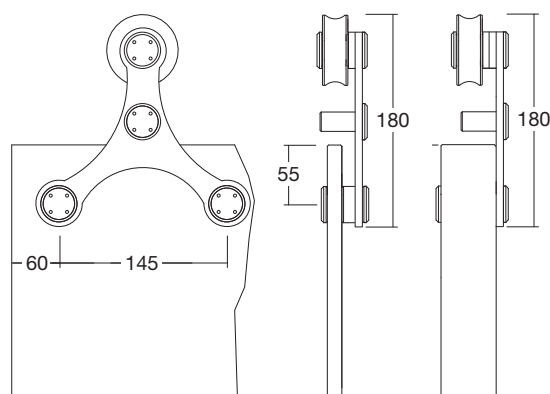

**Cat. No.**  
57548  
57549

#### Hanger, Tritec

For glass doors,  $d = 8-12$  mm  
For wood doors,  $d \leq 40$  mm  
stainless steel, height-adjustable  
approx. 7 mm

**!** Glass drill holes  $\varnothing 12$  mm + 0,3 mm  
Wood drill holes  $\varnothing 10$  mm + 0,3 mm

## Accessories

- Cat. No.**  
57538  
**Door stop**  
For Unotec Home/Object,  
L = 57 mm  
57539  
For Flatec, Duetec, Tritec,  
L = 45 mm  
stainless steel,  $\varnothing$  30 mm

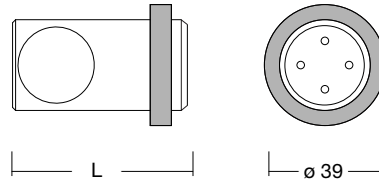

- Cat. No.**  
57540  
**Door stop set**  
Both sides for glass doors  
stainless steel,  $\varnothing$  25 mm  
! Glass drill holes  $\varnothing$  12 mm + 0,3 mm

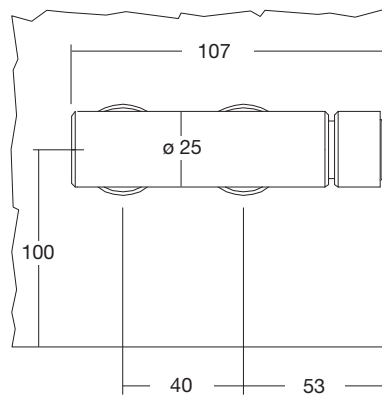

- Cat. No.**  
57550  
**Bottom guide**  
For door leaf, d = 8-12 mm  
stainless steel with felt insert

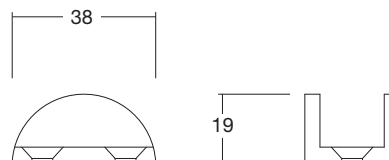

- Cat. No.**  
57551  
**Bottom guide**  
For wood doors, d ≤ 40 mm  
plastic, for groove 7 x 17 mm

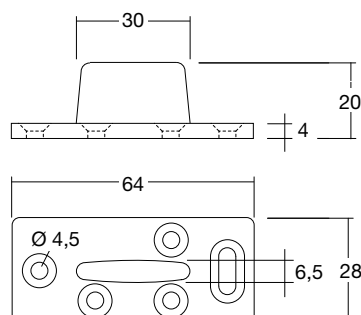



## System components

To round off your individual designs and plans with our sliding door systems, we provide you with a comprehensive range of door handles and flush pulls. You can perfectly complement all glass and wood sliding door systems with the stainless steel handles, shown here as an example. Using various attachment sets, you can mount the handles visibly as well as invisibly, both as single handles and in pairs. All door handles are manufactured in finely ground stainless steel. Please ask us about special lengths. Polished stainless steel surfaces are also available.

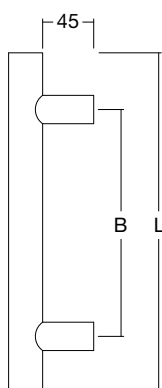

### Door handle Impero ø 25 mm

Cat. No. single handle	Cat. No. handle set	L mm	B mm
57560	57565	400	300
57561	57566	500	350
57562	57567	600	400
57563	57568	900	700

stainless steel

**!** Glass drill holes ø 14 mm + 0,3 mm  
Wood drill holes ø 9 mm + 0,3 mm

**i** Please send us information about the way of mounting and the thickness of door leaf and type of material.

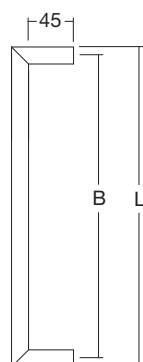

### Door handle Beluga ø 20 mm

Cat. No. single handle	Cat. No. handle set	L mm	B mm
57570	57572	300	280
57571	57573	400	380

stainless steel

**!** Glass drill holes ø 12 mm + 0,3 mm  
Wood drill holes ø 9 mm + 0,3 mm

**i** Please send us information about the way of mounting and the thickness of door leaf and type of material.

## Door handle Thalís Ø 25 mm

Cat. No. single handle	Cat. No. handle set	L mm	B mm
57574	57575	325	300

stainless steel

! Glass drill holes Ø 14 mm + 0,3 mm  
Wood drill holes Ø 9 mm + 0,3 mm

i Please send us information about the way of mounting and the thickness of door leaf and type of material.

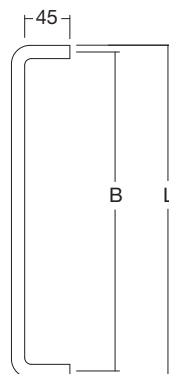

## Flush handles

Cat. No.	Flush handle I		
	Ø A mm	Ø C mm	Ø B mm
57580	70	42	49
57581	90	62	69

For glass doors, stainless steel,  
insertion depth 3,5 mm

! Glass drill holes Ø 50 + 0,3 mm and  
Ø 70 + 0,3 mm

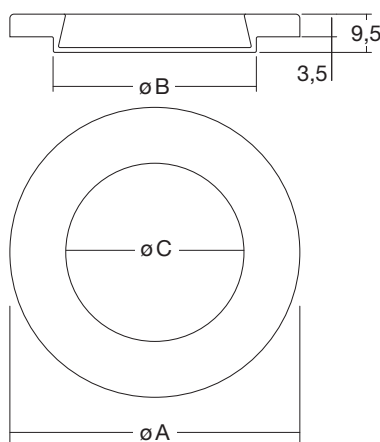

**Cat. No.** 57582 **Flush handle II**  
Specially made for wood doors,  
stainless steel, Ø 75 mm,  
insertion depth 14 mm, with harpoon  
stud for pressing into wood  
! Wood drill holes Ø 67 mm + 0,3 mm

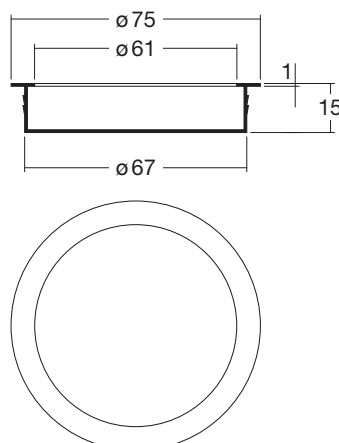

## INSPIRATIONAL DOOR SYSTEMS

Coburn Sliding Systems provides innovative and sustainable solutions for the management of space and sound. At the heart of our operation is the continuing development of our product portfolio. Through our research and partnering with specialist manufacturers, we aim to offer you the widest possible choice.

Pioneers in applying British Standards, Coburn Sliding Systems are committed to quality. A rigorous testing programme ensures consistently high standards across all our products.

## ALSO AVAILABLE FROM COBURN SLIDING SYSTEMS:



Traditional Sliding Systems



Movable Wall Systems

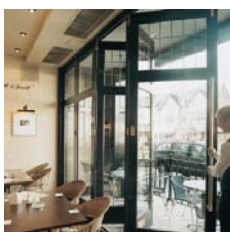

Folding Door Systems



Automatic Door Systems



## HILLALDAM COBURN LIMITED

HEAD OFFICE: Unit 1, Cardinal Way, Cardinal West, Godmanchester, Huntingdon, PE29 2XN

TEL: +44 (0) 20 8545 6680 FAX: +44 (0) 20 8545 6720 Email: [sales@hillaldam.co.uk](mailto:sales@hillaldam.co.uk)

[WWW.COUBURN.CO.UK](http://WWW.COUBURN.CO.UK)

The information in this brochure is given in good faith, however without engagement.

Design subject to alterations.

The illustrations and photos in this brochure do not reflect the scope of supply!



Certificate No. 14679

The products designed and supplied by Hillaldam Coburn Ltd are covered by a Quality Assurance system in accordance with BS EN ISO 9001:2008



**Hillaldam Coburn**  
solutions in sound & space

Coburn Sliding Systems is a division of Hillaldam Coburn Ltd.